

## INSTALLATION

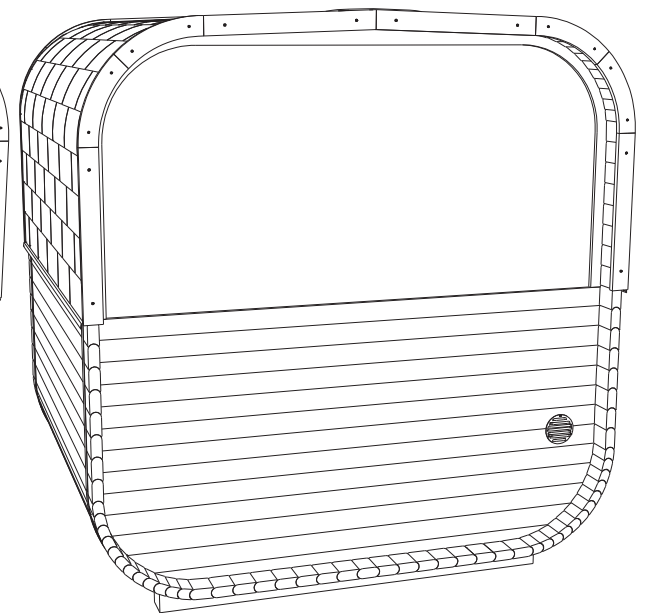
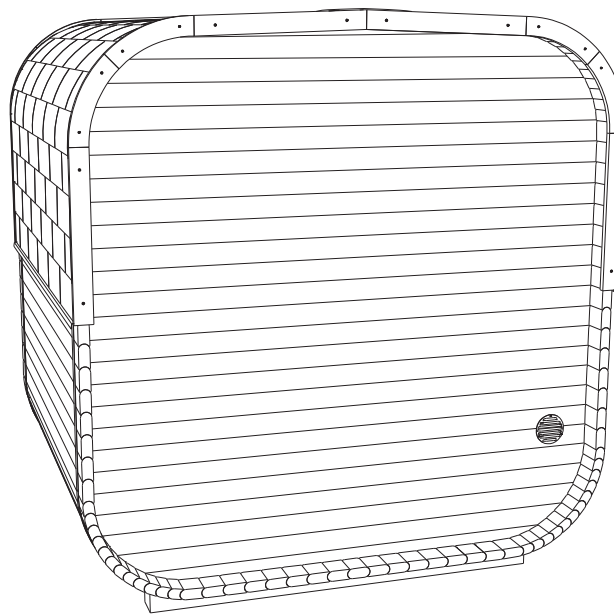
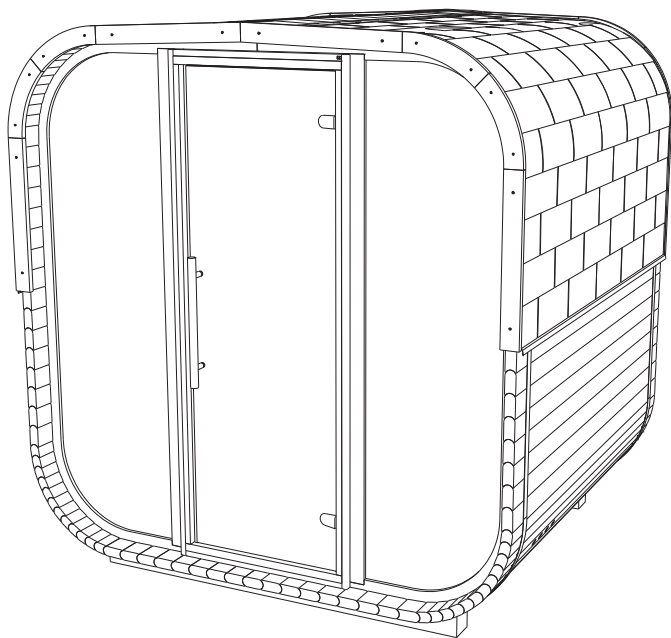

assembly instructions

operating and installation instructions

## PARTS LIST

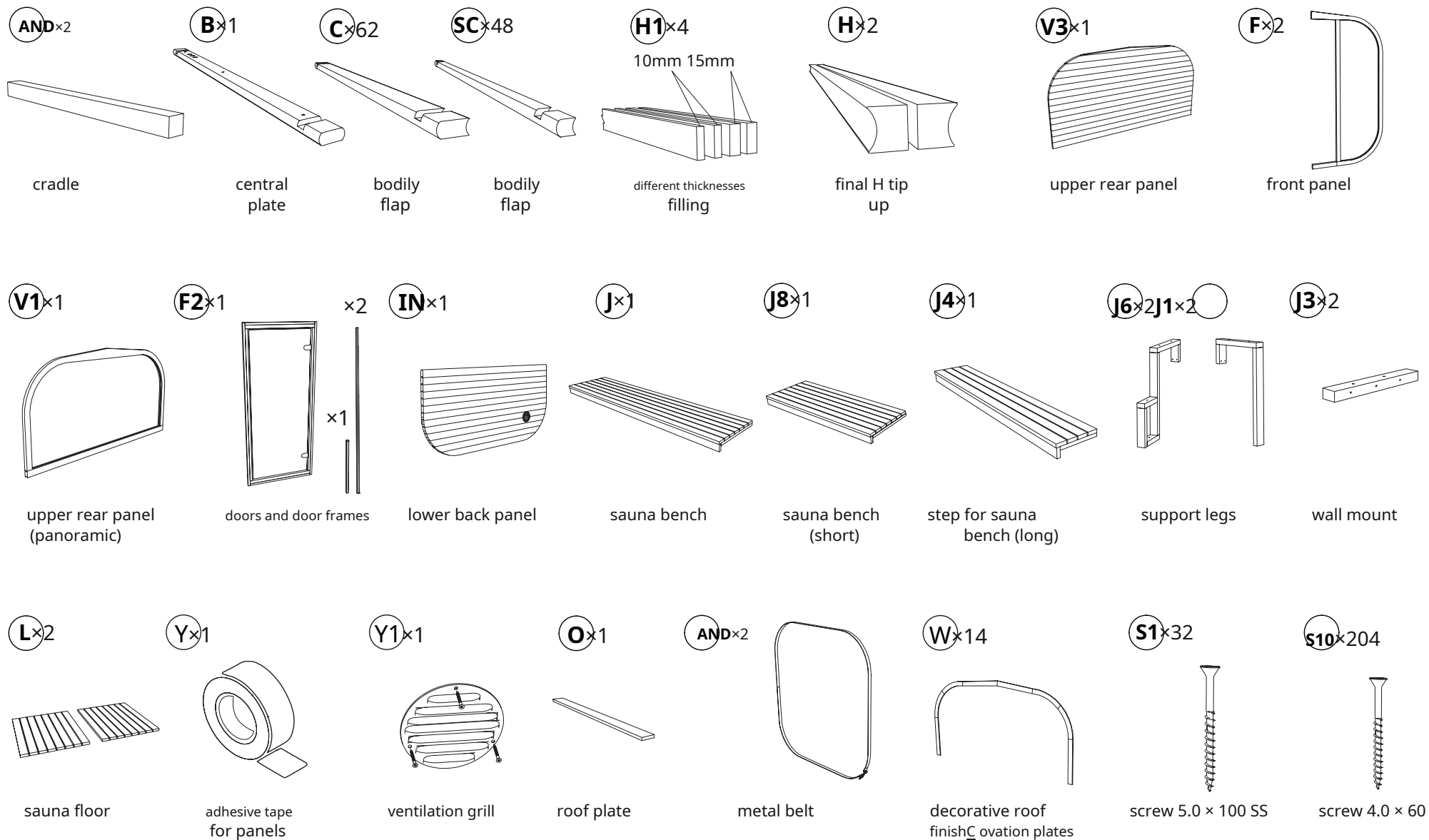

## PARTS LIST

(S5)×23



screw 4.0 × 50 SS

(S4)×2



screw 5.0 × 120

(D)×1

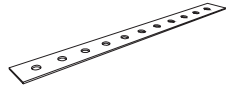

metal holder

(S6)×38



screw 5.0 × 70 SS

(S7)×34



screw 4.2 × 55  
brown

(S12)×6



screw 4.0 × 30

(S14)×8



screw 5.0 × 80

(P7)×1

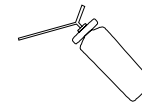

spray foam

(P4)×1

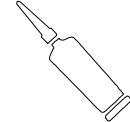

bitumen roofing  
cement

(S9)



×2

screw  
Ø12 × 140

+



×2

hexagonal nut  
M12 (SW19)

+



×4

flat  
washer

×12  
5mm



green

×10  
2mm

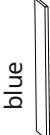

blue

×10  
1mm



red

spacers  
door boxes

(N1)×2



door handle

×2



wooden peg

(P8)×2

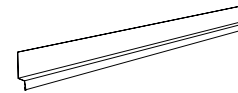

metal cornice

(P5)×1

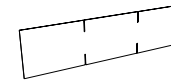

roof shingle  
ridge gutter

(P1)×3

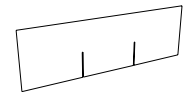

roof shingles

(P2)×4

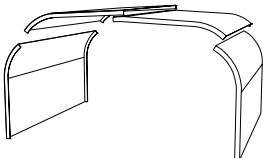

underlay  
roof shingles



shingle nails

## INSTALLATION

**Note: Before and after** When defending the building, read the operating instructions!

### RECOMMENDATION



**2 people are recommended for assembly**

Before you begin, make sure the sauna will fit in your chosen space. Make sure the area is level and free of standing water after a rain. Concrete, paving stones or crushed stone are preferred.

Check the parts before building.

### TOOLS NEEDED

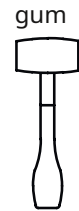

gum



0.45m - 2m



3-5mm

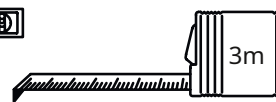
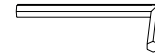

3m

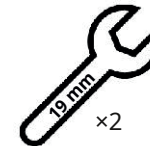

x2

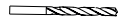

O 4-10 mm

**STEP 1:** Place the boards skulls on the prepared surface. The base for the sauna cradles must be solid. We to be level and the edgesmeasure diagonally from corner to corner. Dimensions "and" "b" The distance should be the same. between the cradles is 1335 mm. There has been no change in the dimensions on Attach the boards so thateither side of the cradles. Check again with a spirit level. Pre-drill holes before by attaching the cradles to the screwing in the screws. Attach the pulley in the middle of the cradles. Leave 150 center plate(B).

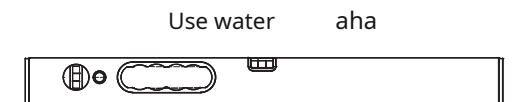
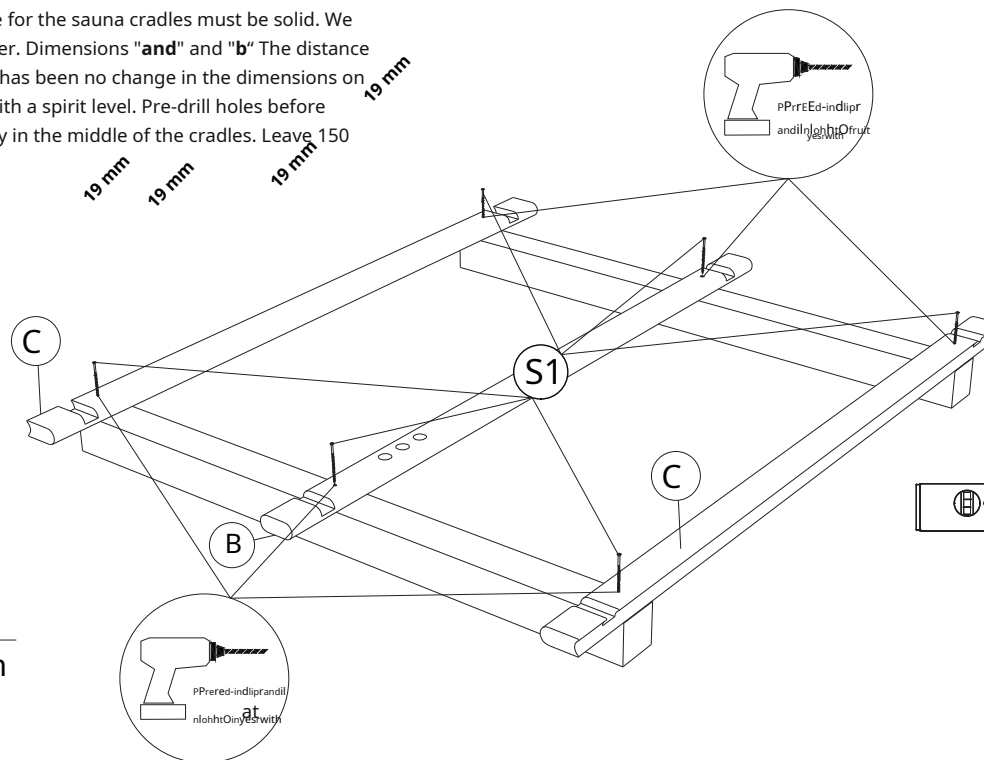
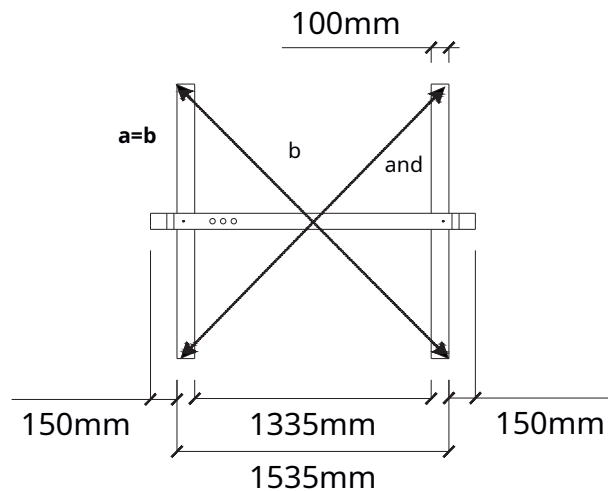

Use water

aha

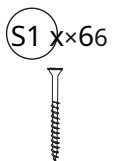

S1 x66

## INSTALLATION

**STEP 2:** Attach 10 pieces of wood to each side of the center board(C). When installing the boards, check the level and use a rubber mallet for a more secure fit. Pre-drill the holes for the screws. Use spray foam between the boards for better insulation.

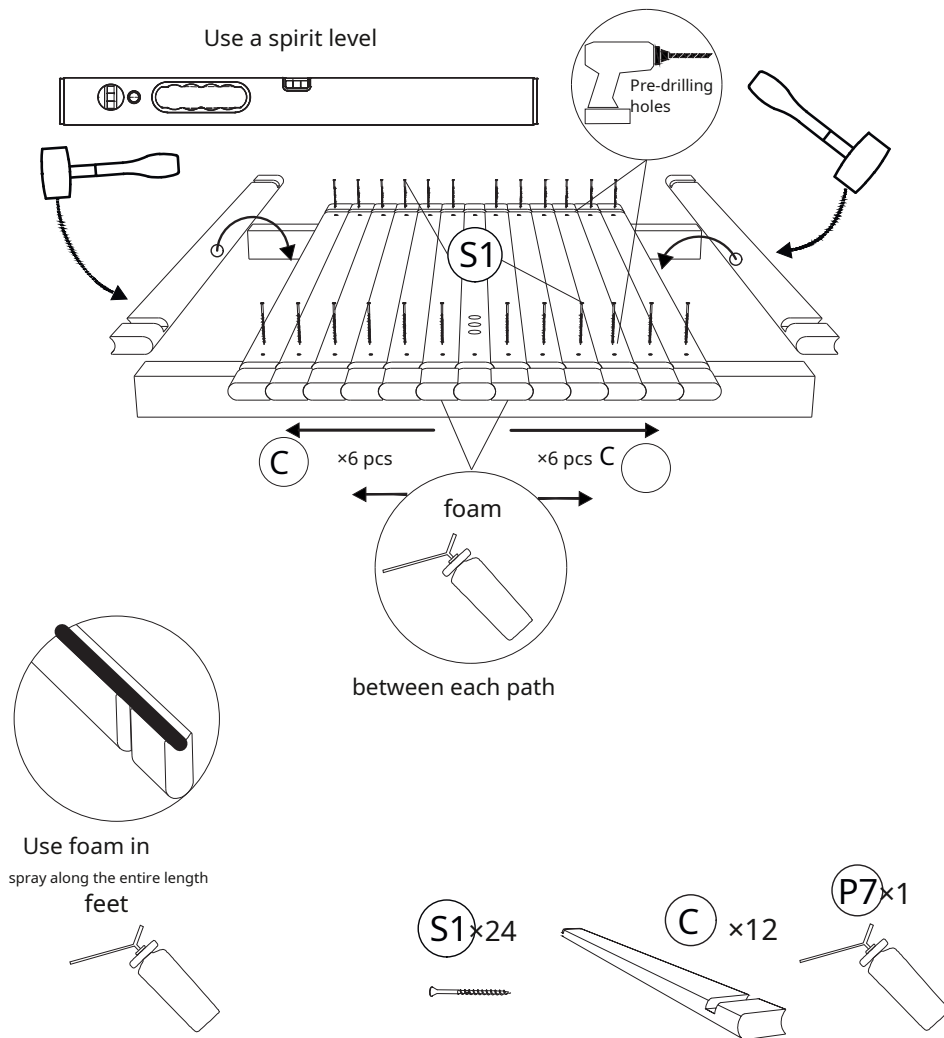

**STEP 3:** Drill fourteen 10mm holes on the side grooves in the front and rear walls on the outside of the board as shown in the picture below. This will help drain excess fluid faster.

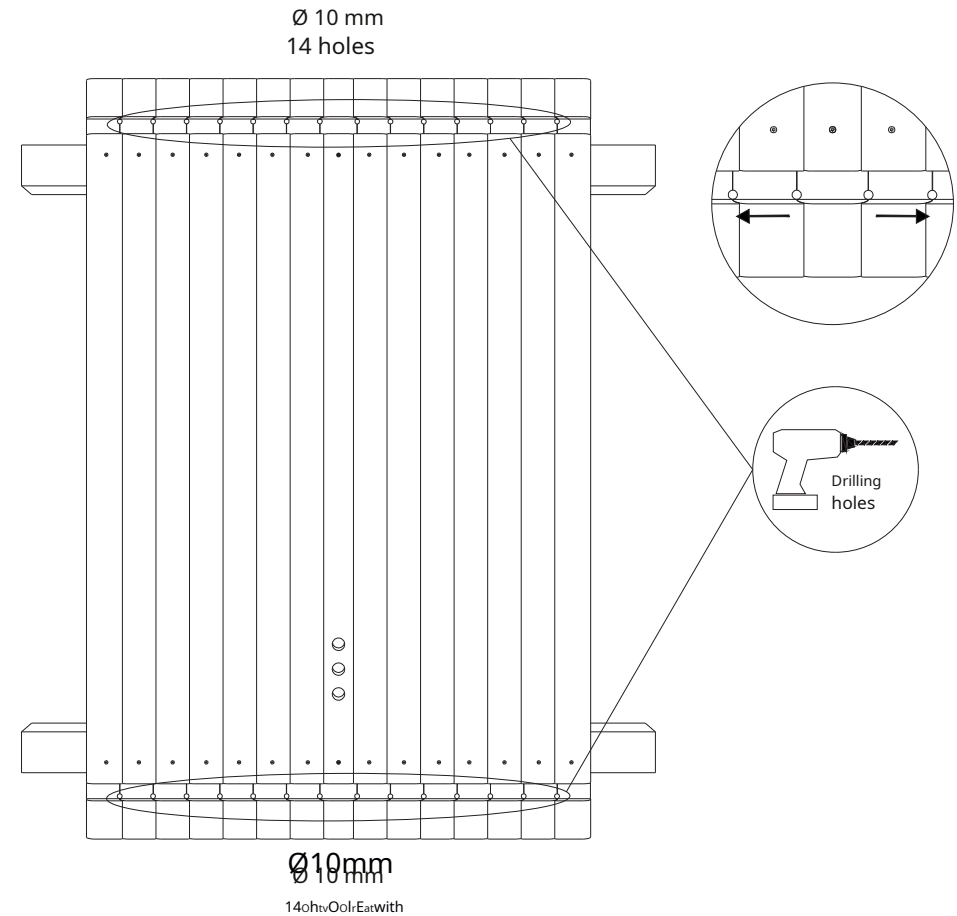

INSTALLATION

**STEP 4:** Stick the adhesive tape along the edge of the back panel. At the bottom of the back panel (IN) Draw a line where the center of the panel is. Do the same on the center foot of the floor where the panel will sit.

**STEP 5:** Place the rear bottom panel (IN) into the groove of the board. Check that z Secure that is a panel in the plains E. the panel with screws (S10) in both corners through the groove.

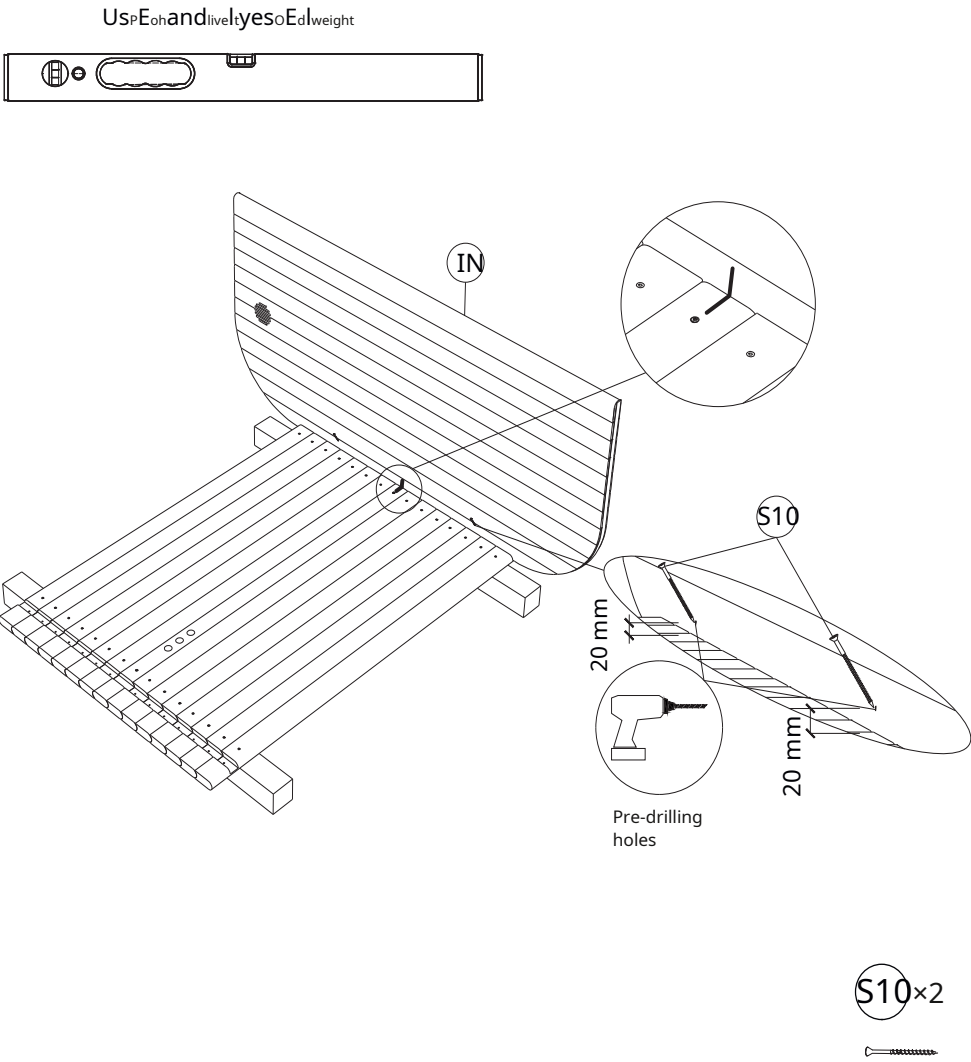
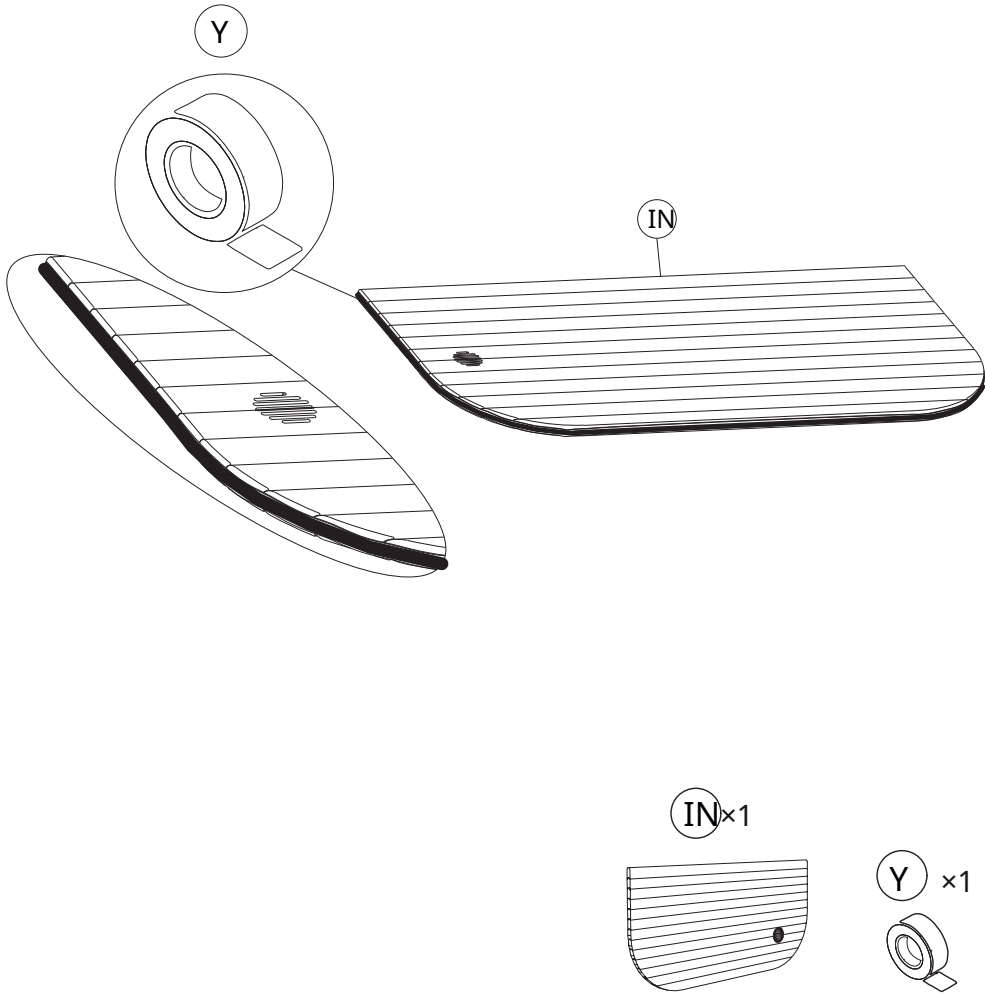

## INSTALLATION

**STEP 6:** Along the edges of both front panels(**F**)Apply adhesive tape. Insert a wooden dowel into both holes at the top and bottom of the front panel. Pre-drill holes in the panel sill, evenly spaced and not too close to the sides.

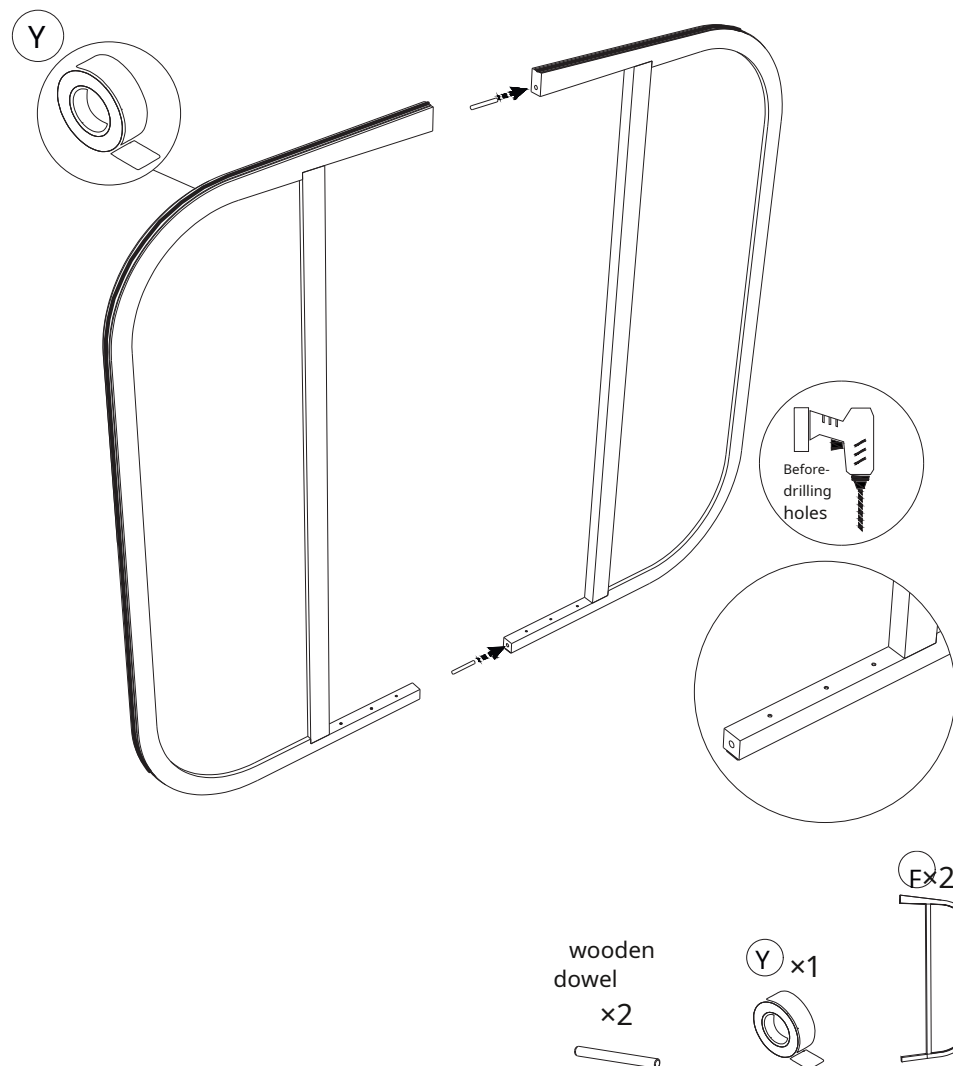

**STEP 7:** Draw a line on the center board where the center is. Take one from boards(**F**)and place it right next to the center line. Take one foot and connect both the front panels, p and back, using screws(**S10**). Fix it on the threshold of the panel using screws(**WITH 2**). Make sure it is in a horizontal position.

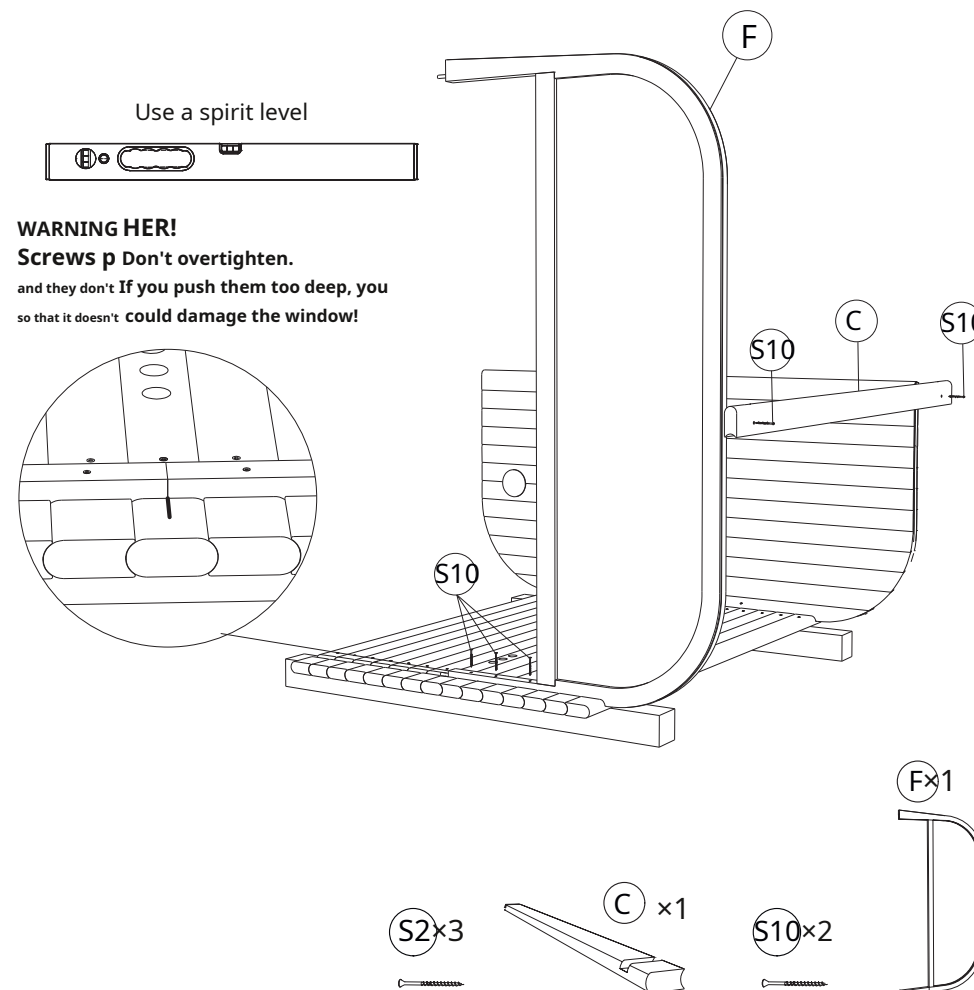

# INSTALLATION

**STEP 8:** Place the second front panel(F). Slide the joint part. Fix it on the threshold of the panel by horizontal position. Use the metal bracket to mount the joint together.

**WARNING!**

Do not overtighten the screws.  
and!Don't screw them in too deep.

Eandrt... me... withpCorwithEaswithEandn... windows!

ing them too deep to  
damage!

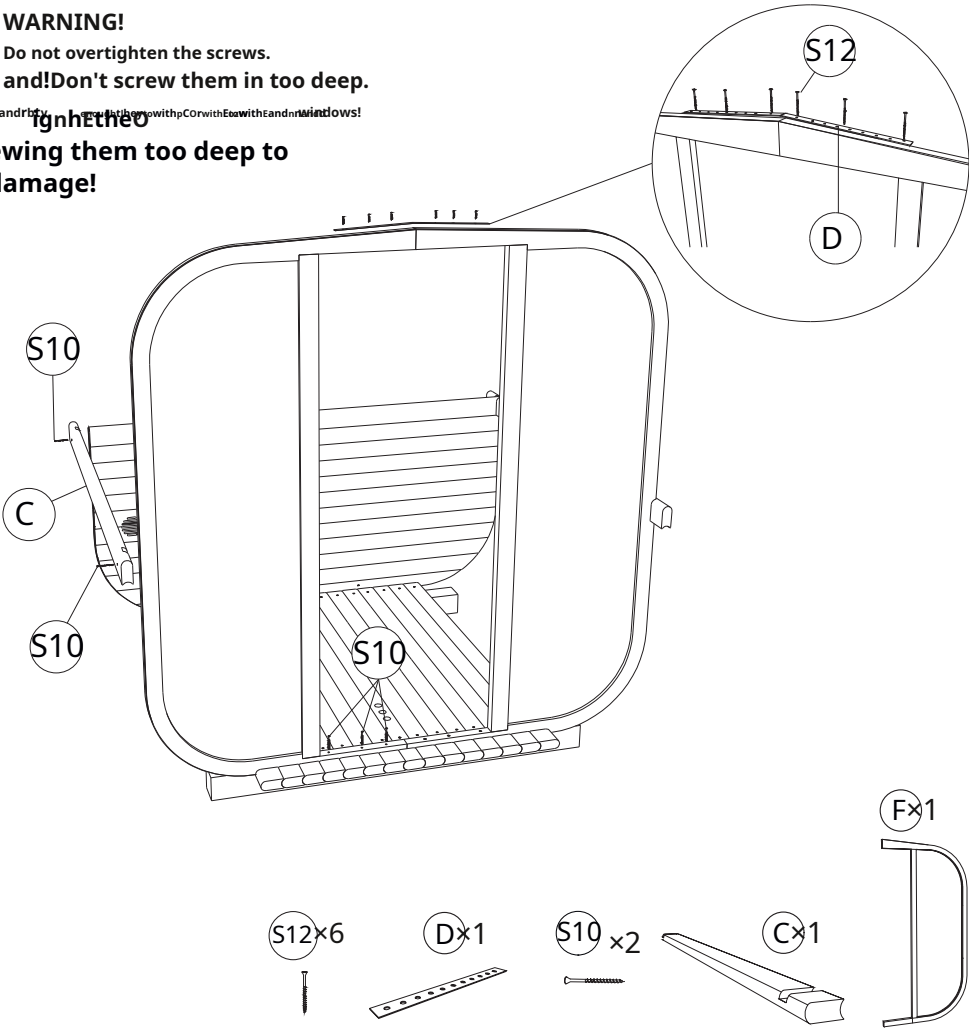

**KRO To 9:** Attach one plate(C)on both sides with screws(S10). use a rubber For p mallet for the outer placement. Use a hammer between each foot. syringe new foam.

**VAR OVATION!**

Screw Do not overtighten.  
and you Screw them in too deeply, the  
so that windows will be damaged!

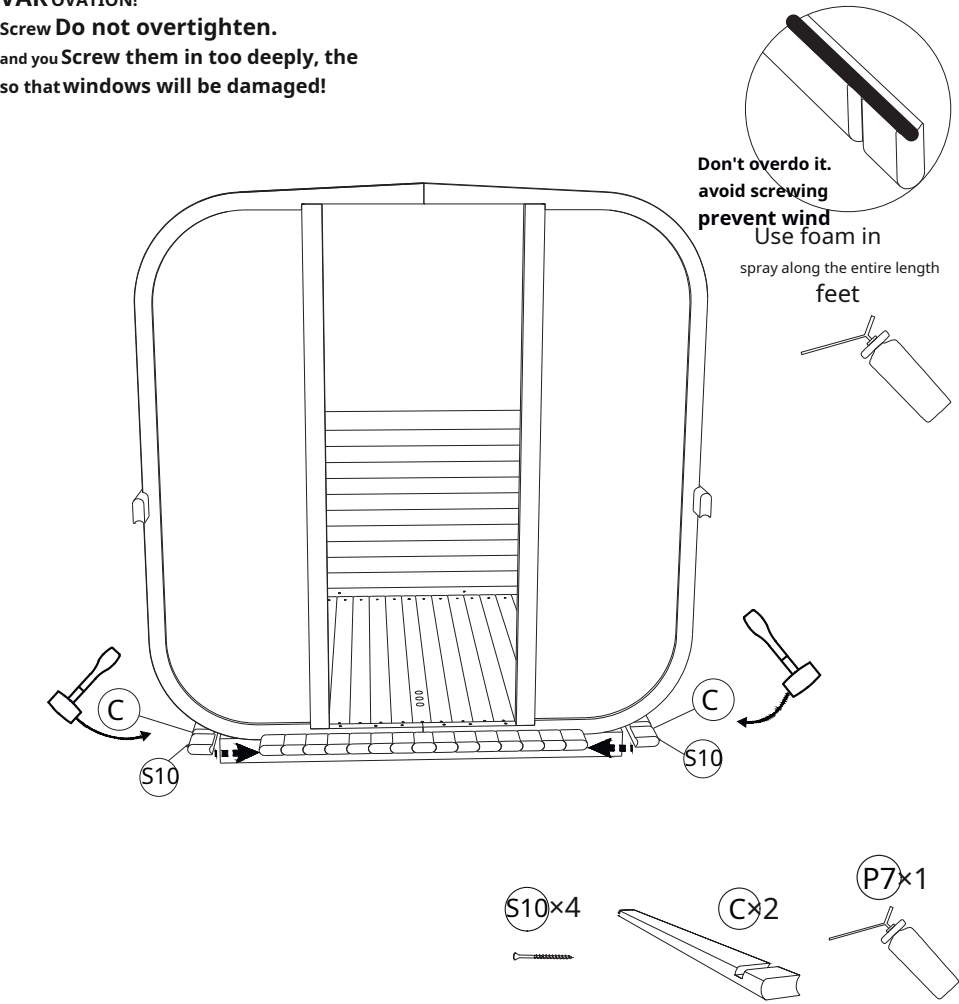



## INSTALLATION

**STEP 10:** Attach 12 feet(SC) on both sides. For a firmer fit, use rubber mallets. When both corners are finished, remove the connecting

after the by the power of grafts (S10).  
o. Between each oh my a piece of cake Use foam.  
feet.

### WARNING!

Do not overtighten the screws.  
and do not screw them too deep to  
avoid damaging the windows!

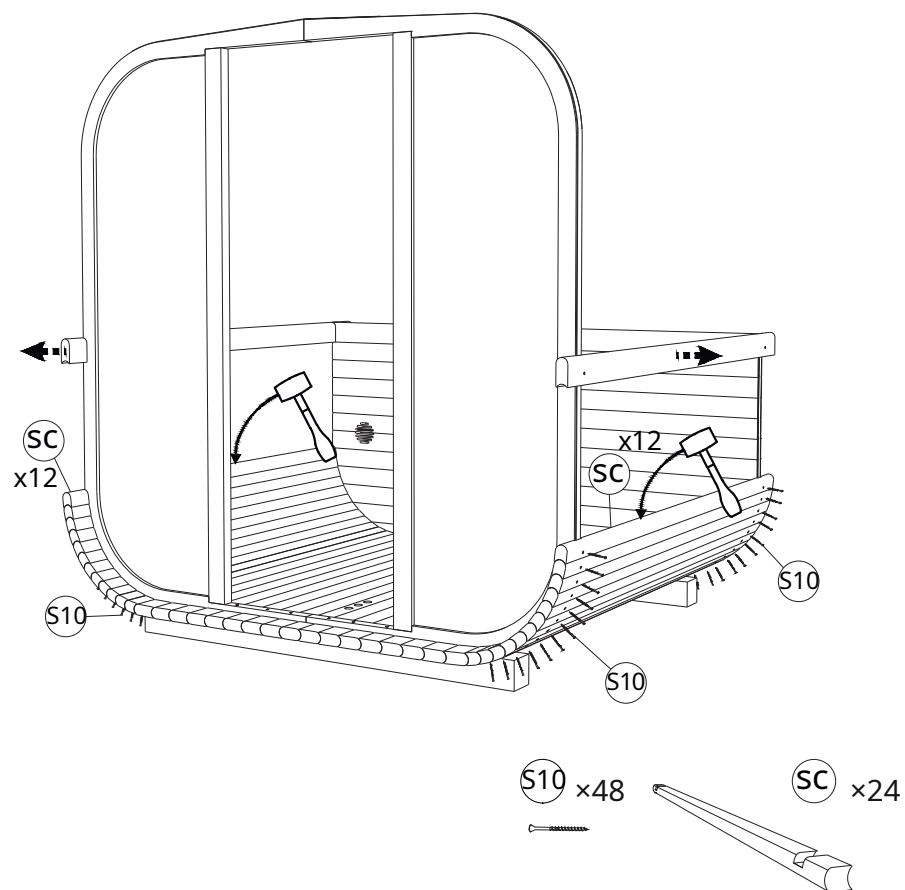

**TOEAR 11:** Attach one plate(C) on both sides using 4 × 60 screws(S10).

P a firmer one Use a rubber mallet to place the feet. Use foam between each foot.

TOOnce both corners are complete, remove the connecting plates. Continue attaching the pieces until you reach the top of the back panel.(IN).

### IMRRIVING!

Weedry good Don't tighten it.  
and not screw them in too deeply to  
and avoid damaging the windows!

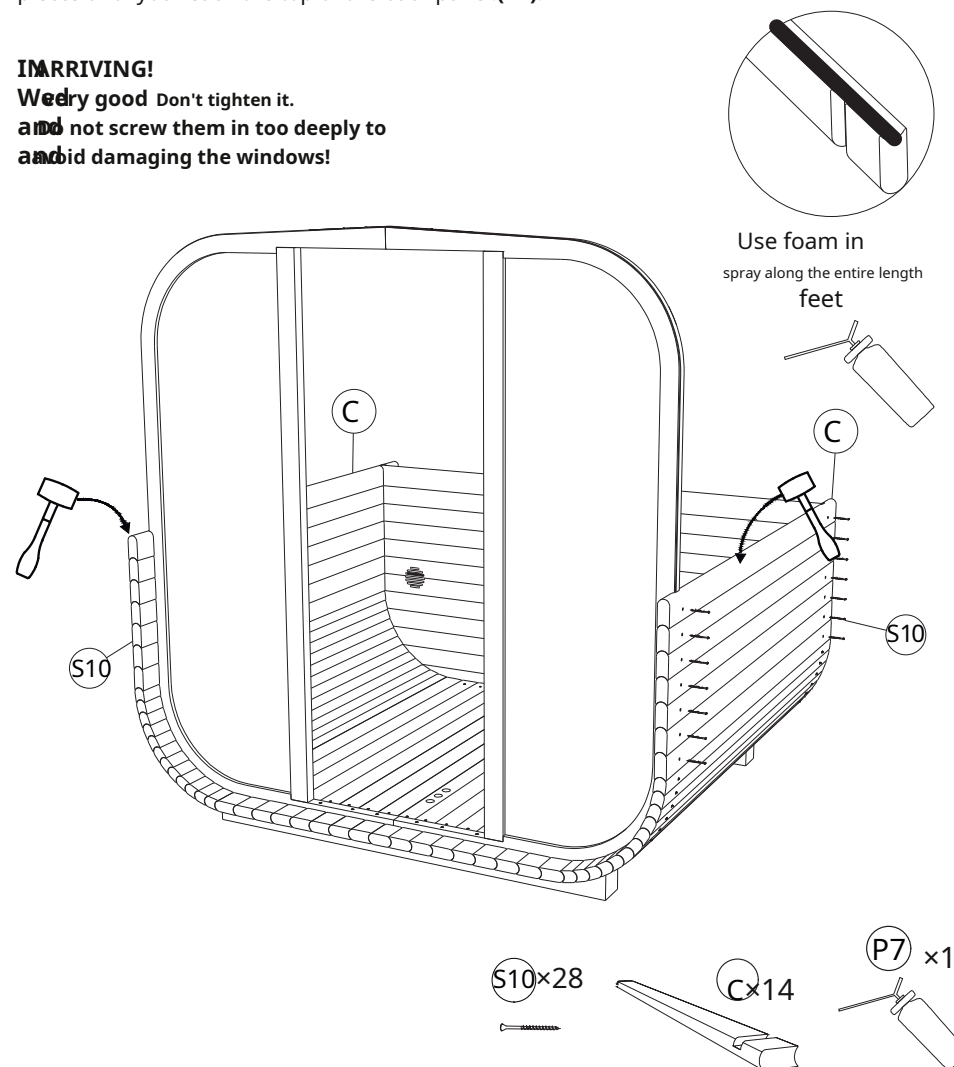

## INSTALLATION

**STEP 12:** Along the rear panel with the edge of the window(V1) or panel(V3) stick the adhesive tape.

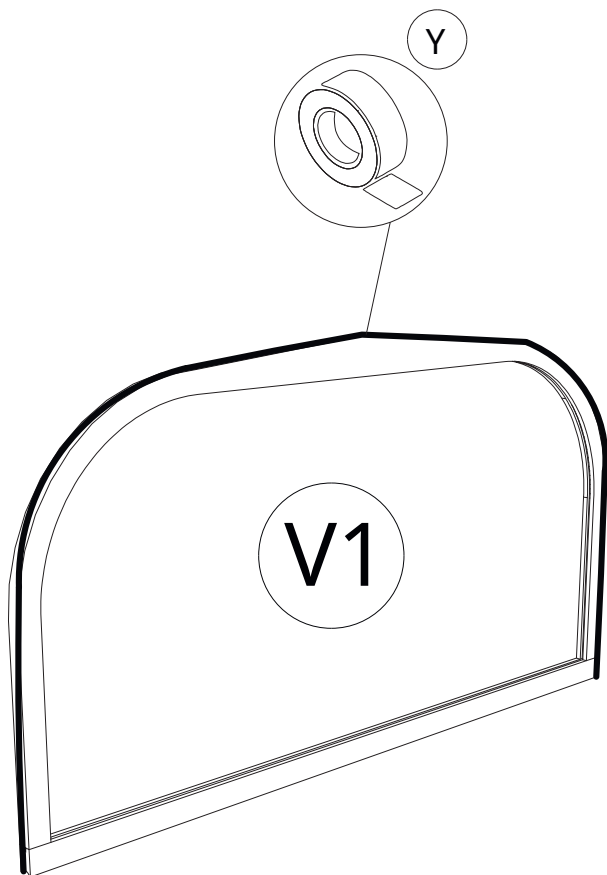

**STEP 13:** Carefully mount the panorama between the attic panel(V1) and the back panel(IN). For better insulation, use foam panels. Place it on the bottom and make sure the side edges are aligned with the bottom and the top of the panel. One worker holds the panel while the other secures the side plate to the arch with screws using screws(S10). Panel(V1) is secured using screws(S4) in both corners using two screws.

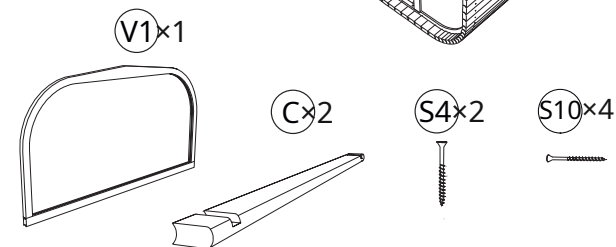
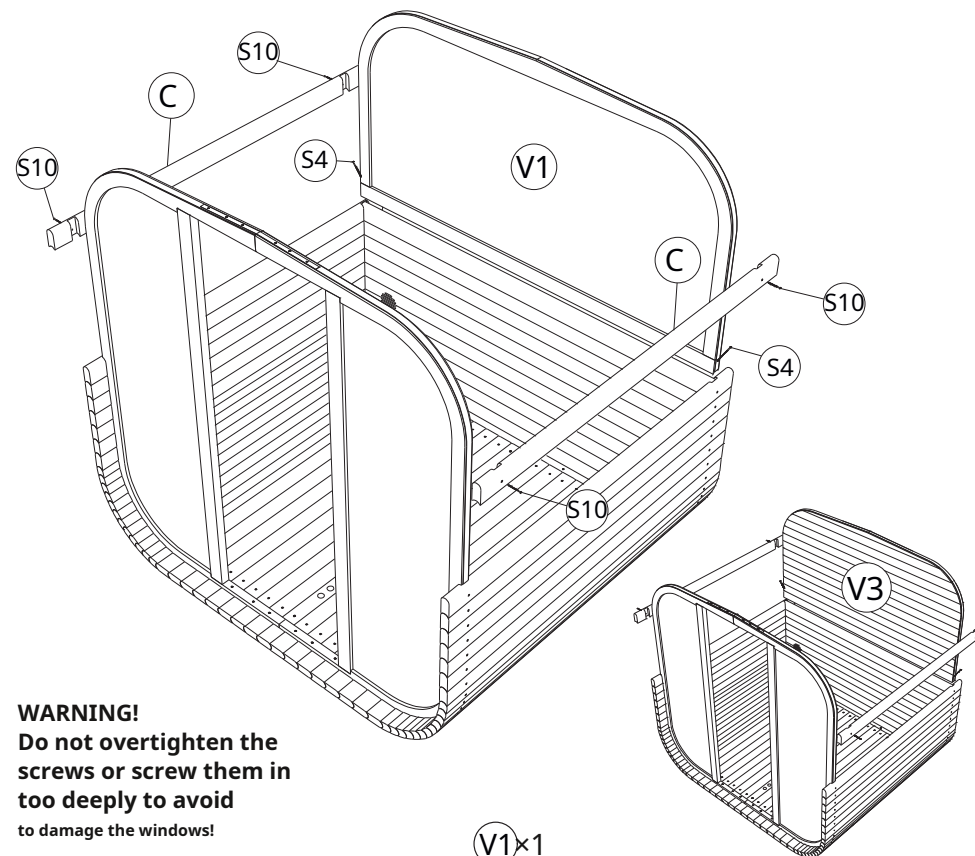

## INSTALLATION

**STEP 14:** Using screws (S10) Use a rubber hammer to secure the location. Use screws (S10) to secure the location. Attach the last 6 bars (C). Between the battens use foam.

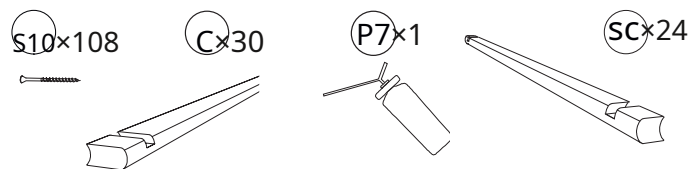
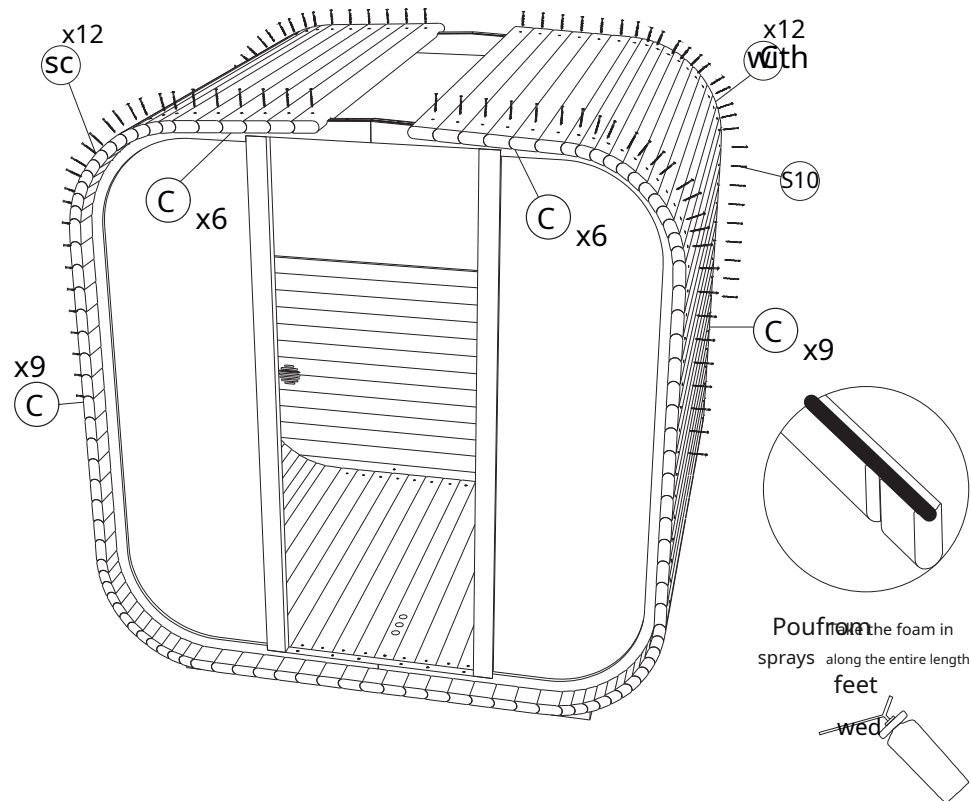

**BOOK 15:** Use thinner E. Echo using 2(C) battens and last battens (H) to finish (H) make 1 to fill the gap between the battens (H) and ensure it is centered d wed apply the echy firmly filled, and then fix it p

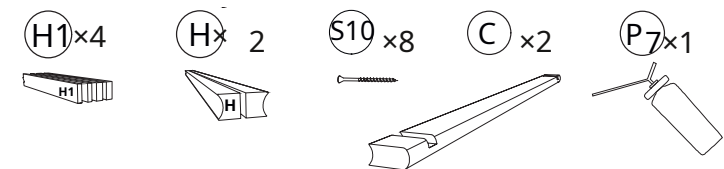
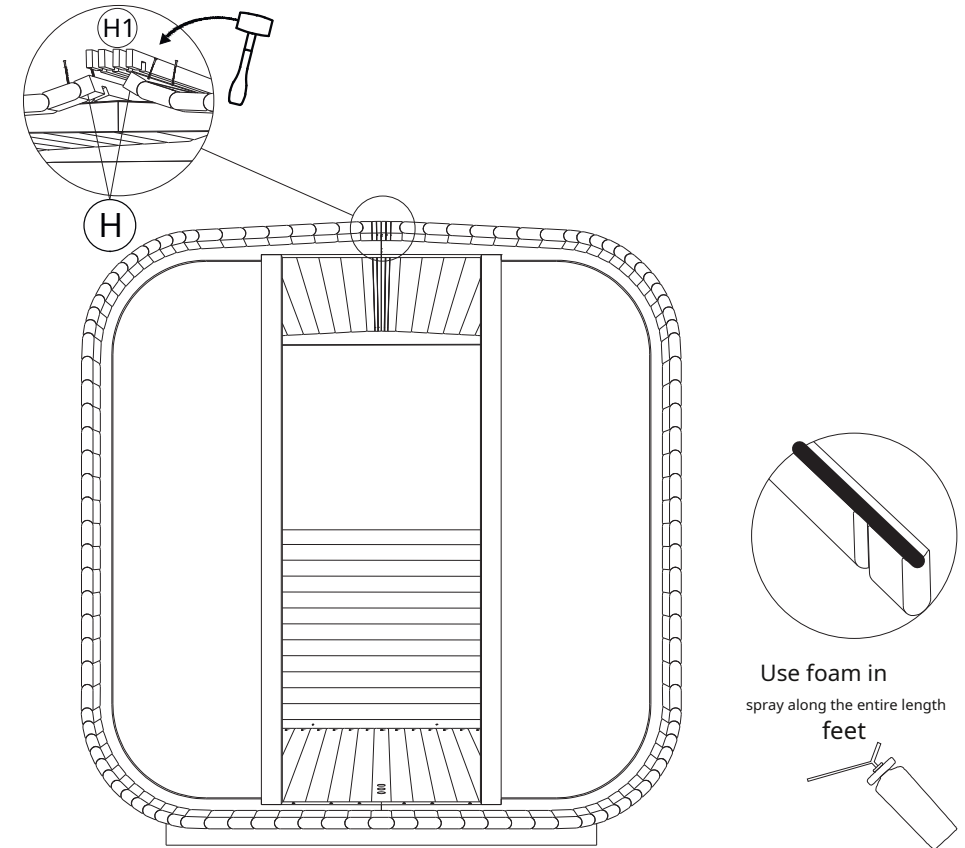

## INSTALLATION

**STEP 16:** Place metal strips on the screw heads. Screws(S9) must be placed in the lower corner of the sauna as shown in the picture, then tighten the screws. Check that the straps fit evenly around the entire perimeter of the sauna 95-100 mm on both sides. Tighten the straps until you feel a strong resistance, the straps must not be loose. After a few days, tighten the straps again.

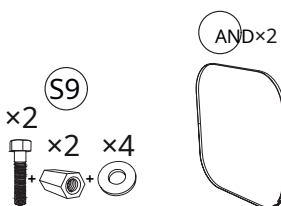
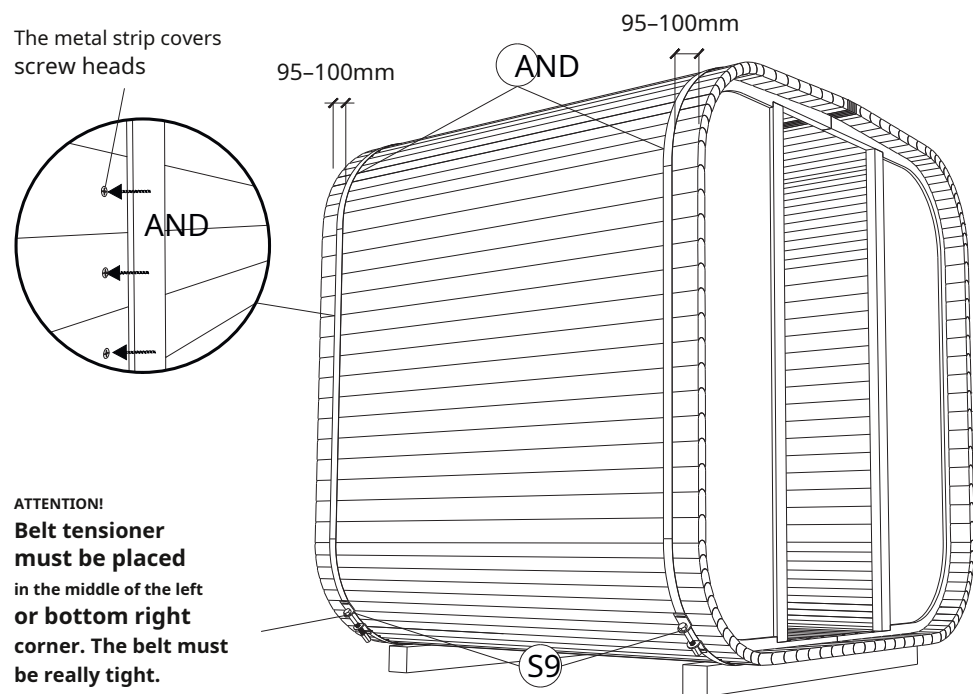

**STEP 17: Nains** Install the ventilation grille from the outside over the ventilation slots.

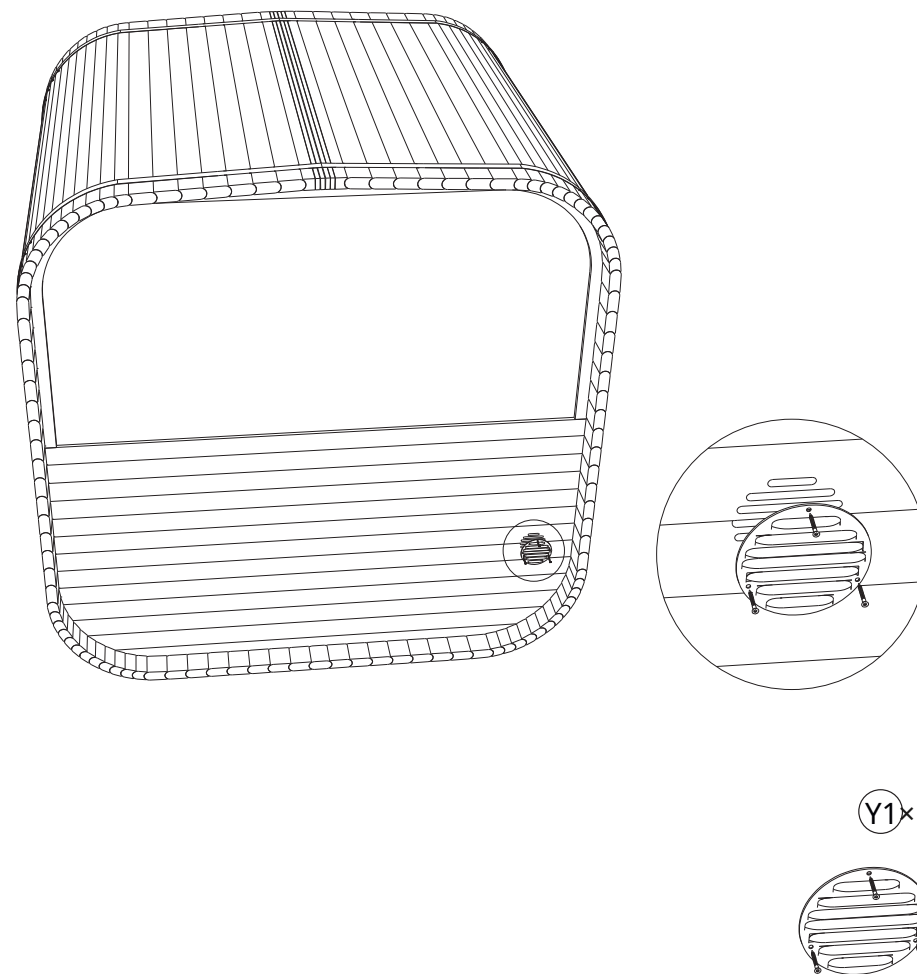

## INSTALLATION

**STEP 18:** Install the door (**F2**). Place the door on the threshold and place it in the frame approximately in the middle. Secure the door with clamps or have another person hold it.

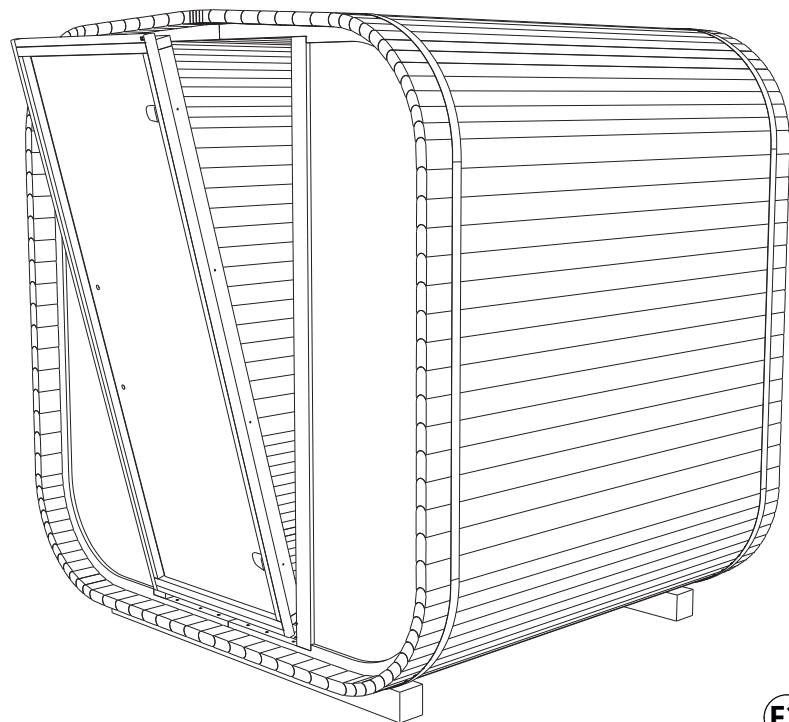

**F2** × 1

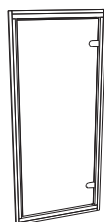

**STEP 19:** Into the gap plastic spacers width. Spacer

Insert a spacer between the door cabinet and the front panel at the screw location. shims. Combine spacers to achieve the largest possible y must fit snugly.

Use Eohand live lyeso Edlweight



Example  
5 × 15  
**GG**



Example  
5 + 2 + 2  
**GBB**

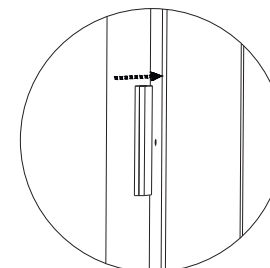
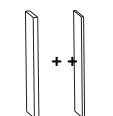

# **INSTALLATION**

**STEP 20:** Fix one side of the door cabinet with screws(S14)slightly outwards over the spacers. Then insert the spacers on the other side. Connect the spacers to the required width. The spacers must fit snugly and not slide down before the door is secured with screws. Use screws to secure the door(S14). Check the door jamb, both sides should be straight, not bent in or out.

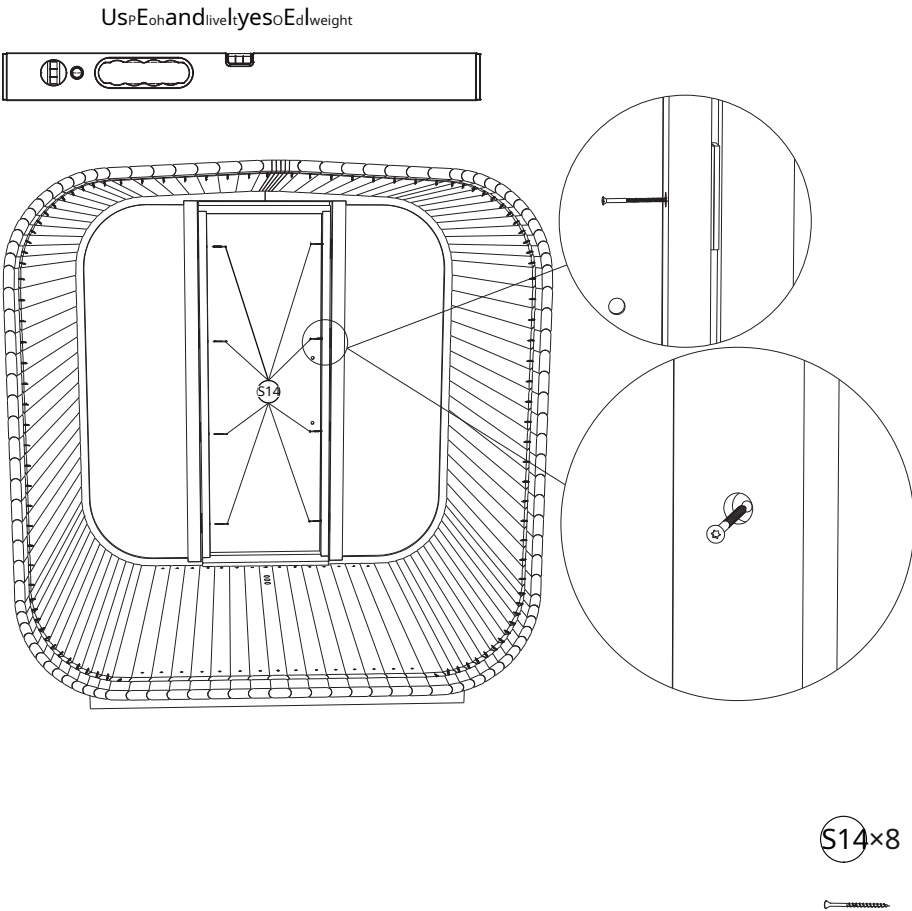

**STEP 21:** Use spray to dry. Excess while it is wet. Attach with(S5).

Spray foam around the door box. Leave the foam in the sprayer and the amount will go down easily if you don't touch it, then apply it to the door moldings on both sides and the top of the door.

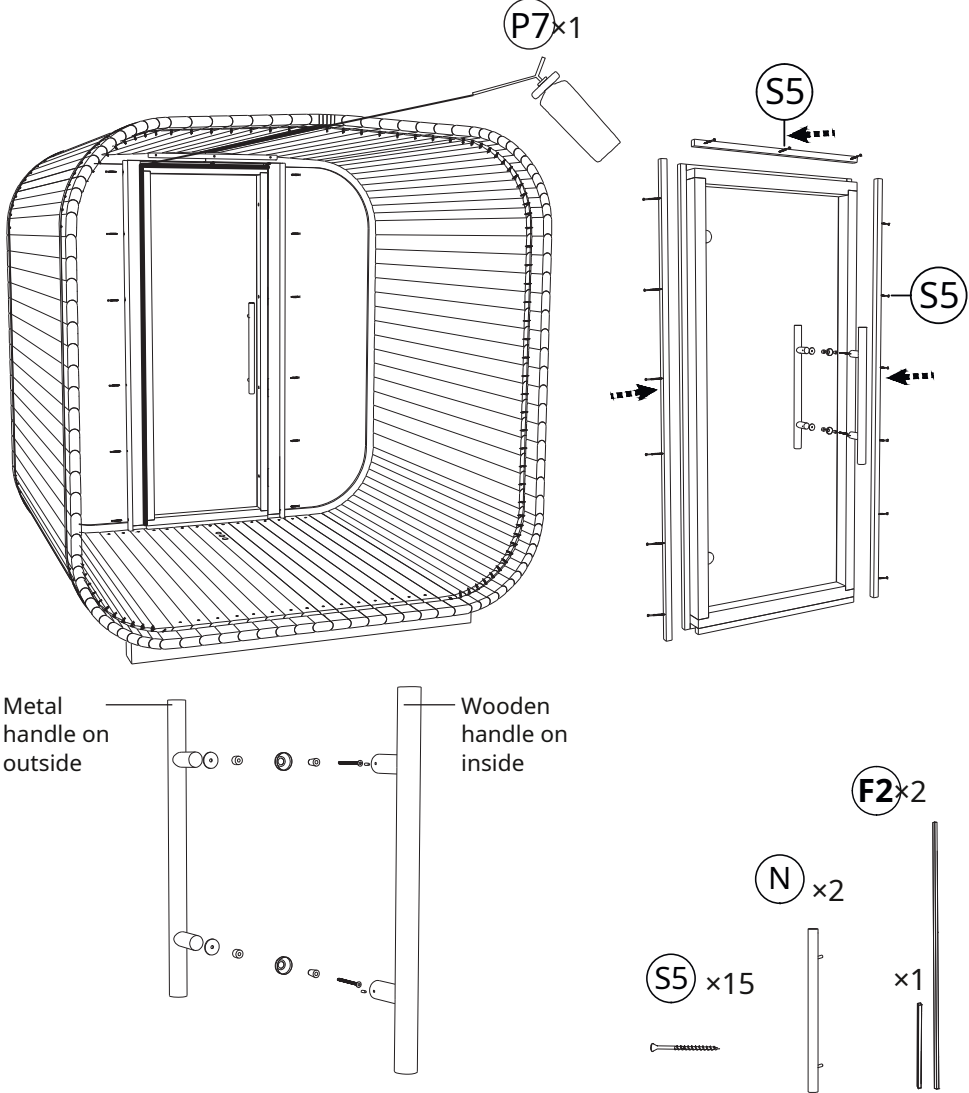

## INSTALLATION

**STEP 22:** Install the bench legs (**J6**) using screws (**S6**). Take measurements as shown, both feet (**J6**) are 590 mm from the side walls. Check that the legs are straight from all sides and angles.

**Notice!**  
Use Brand Edlweight

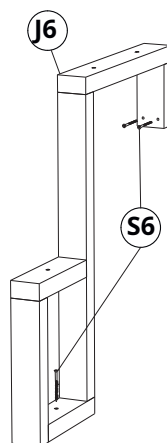
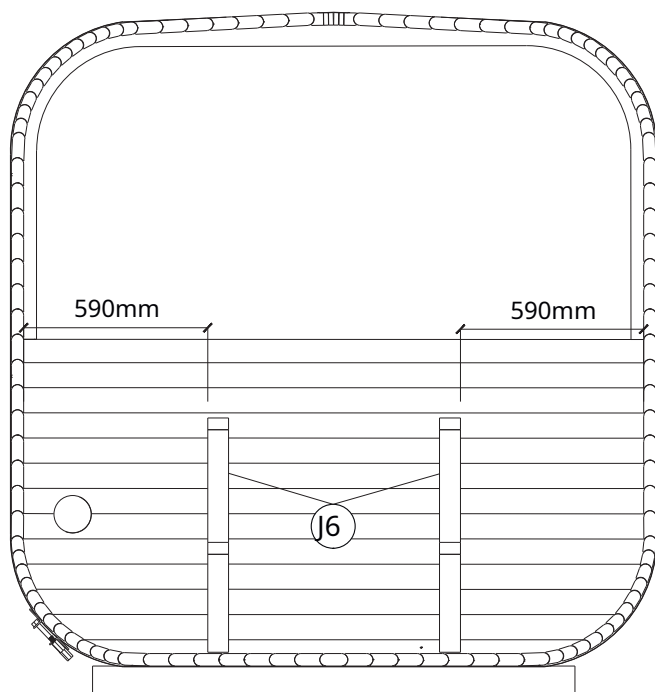

**J6**×2

**S6**×6

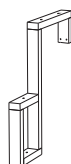

**STEP 23:** Place the long sauna bench up on the bench legs. Then on the side walls mounted and bench support boards (**J3**) using screws (**S6**) at the same level as bench legs from the back wall about 20 mm.

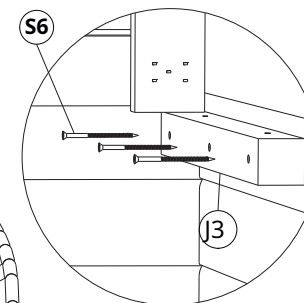
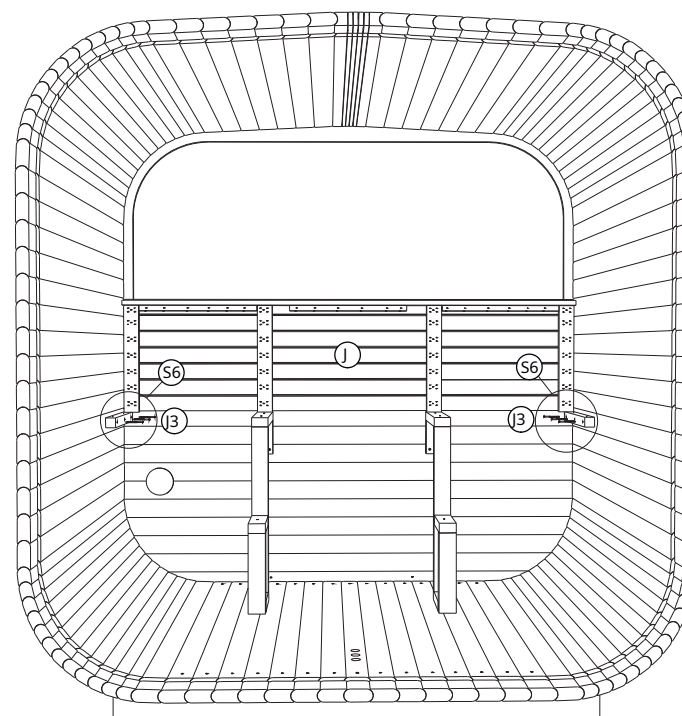

**S6**×6



**J3**×2



**J**×1

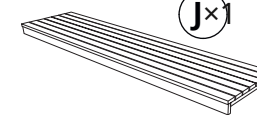



## INSTALLATION

**STEP 24:** Using (S6) install the bench (J) on the top of the legs (J6). The bench cross-boards must match the tops of the bench legs. Attach the bench step (J4) using screws (S6).

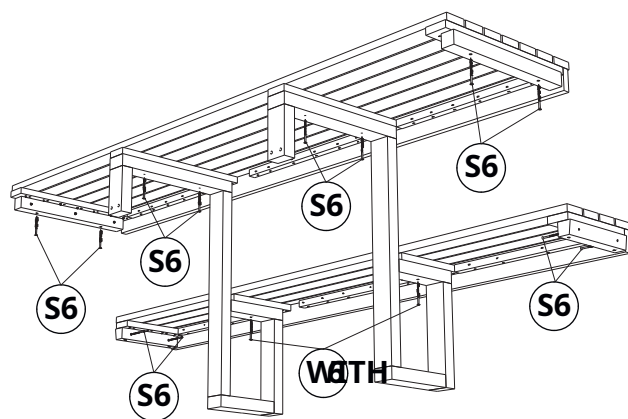
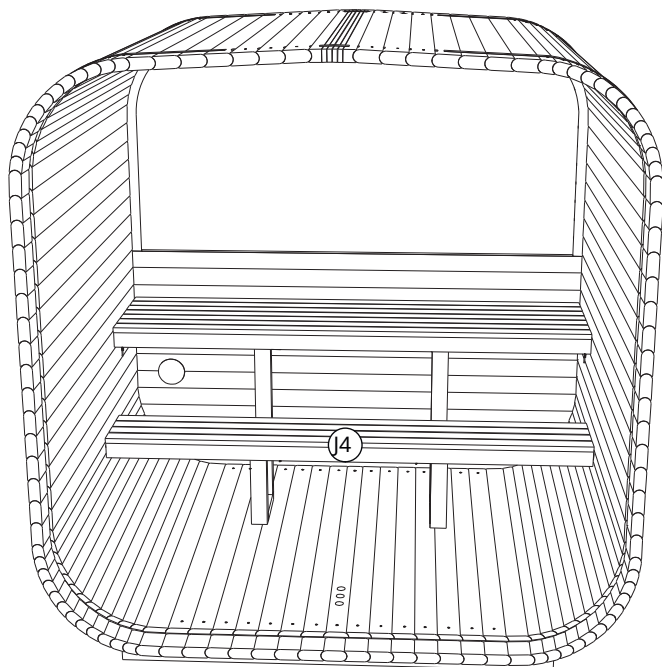

(J6) x 4



(J4) x 1

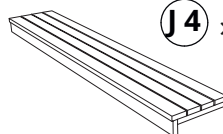

**STEP 25:** Install the bench legs (install J1) using screws (S6). The left foot is needed next to the front panel (F panel. Attach), the right leg is 750 mm from the lower rear the sauna bench (J8) using screws (S6).

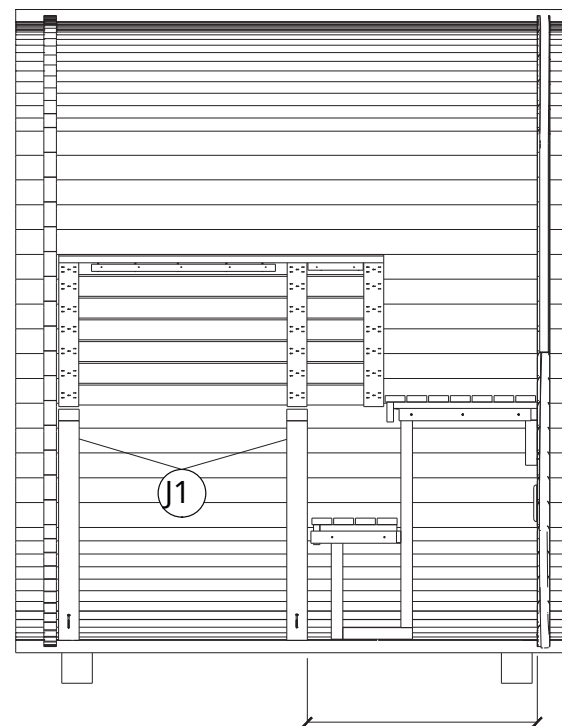

750 mm

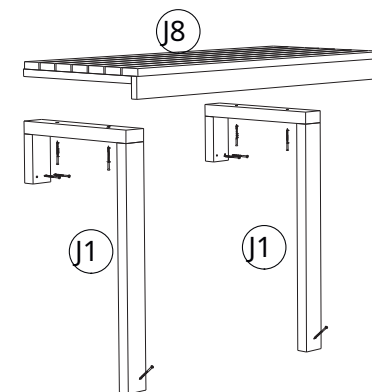

(S6) x 10



(J8) x 1

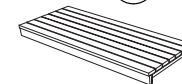

(J1) x 2





## INSTALLATION

**STEP 26:** Install the ceiling plate(**O**)in the middle of the ceiling, pre-drill holes for the screws(**S5**). Lay the sauna floor(**L**).

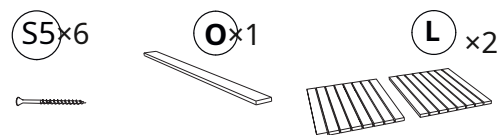
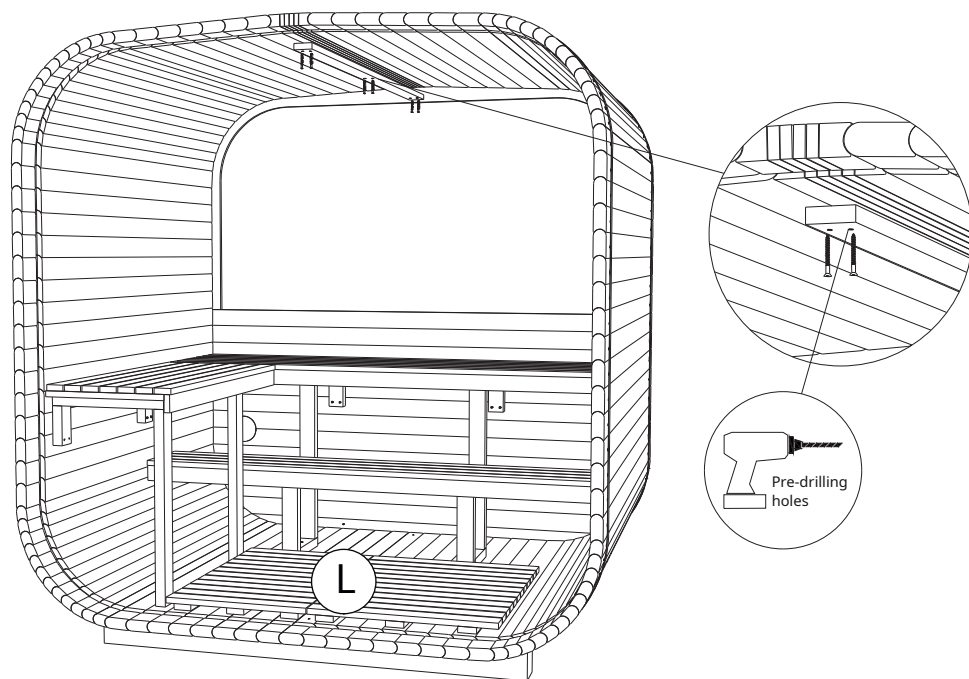

**STEP 27:** Place the top edge of the raindrop 1210 mm from the ground. Make sure that it is level. Fasten the indel nails.

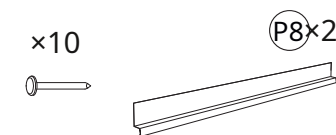
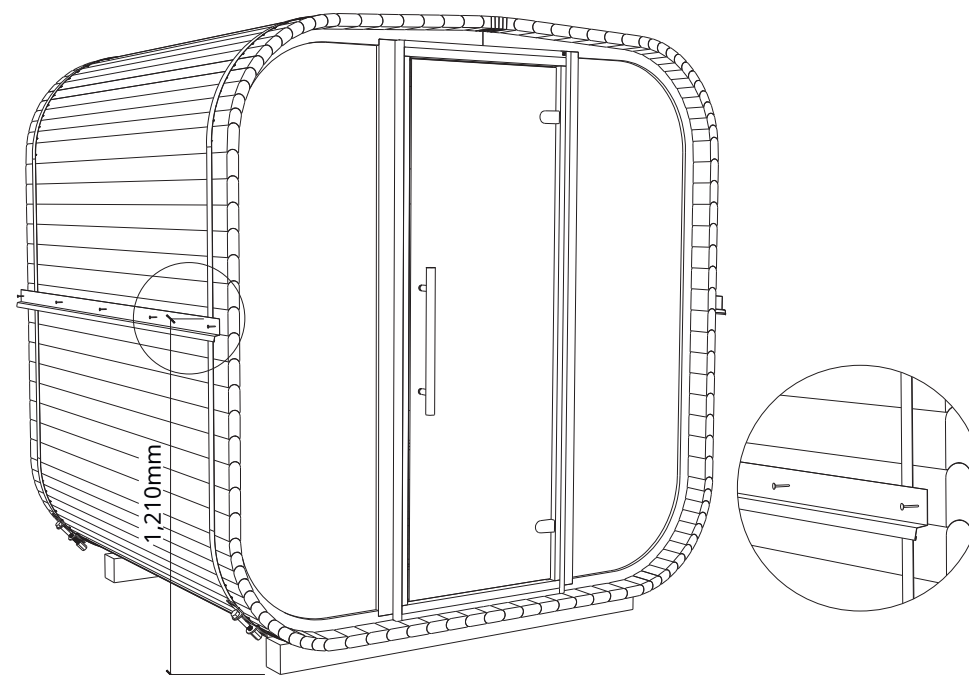

## INSTALLATION

**STEP 28:** First attach the underlayment on both sides. The top underlayment overlaps by at least 100mm on both sides. Leave the underlayment about 40mm above the back and front edges, making sure it is even on the sides.

**STEP 29:** Sew the backing on the front and back edges. Trim off any excess tape if mean necessary.

1,210mm

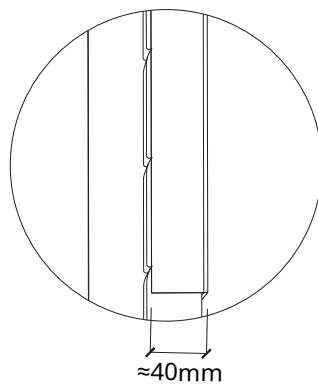
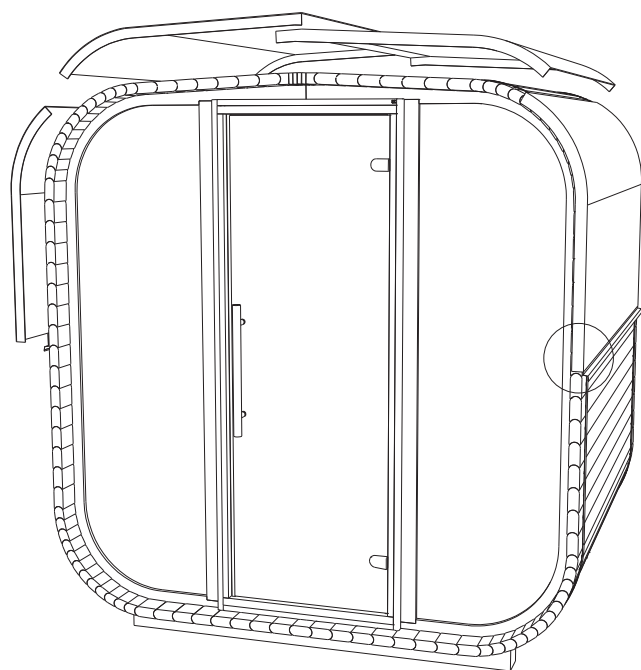

P2x4

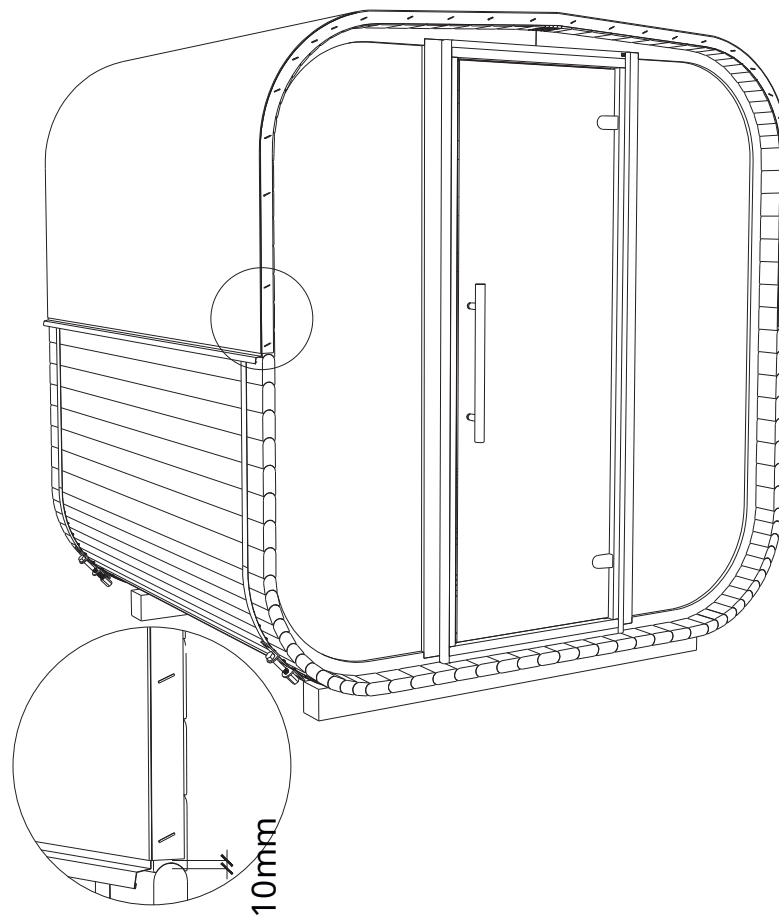
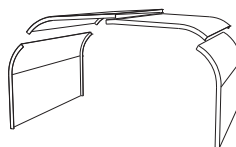

## INSTALLATION

**STEP 30:** Remove the protective film next to each other. Then attach them with nails to the excess part of the starter shingle.

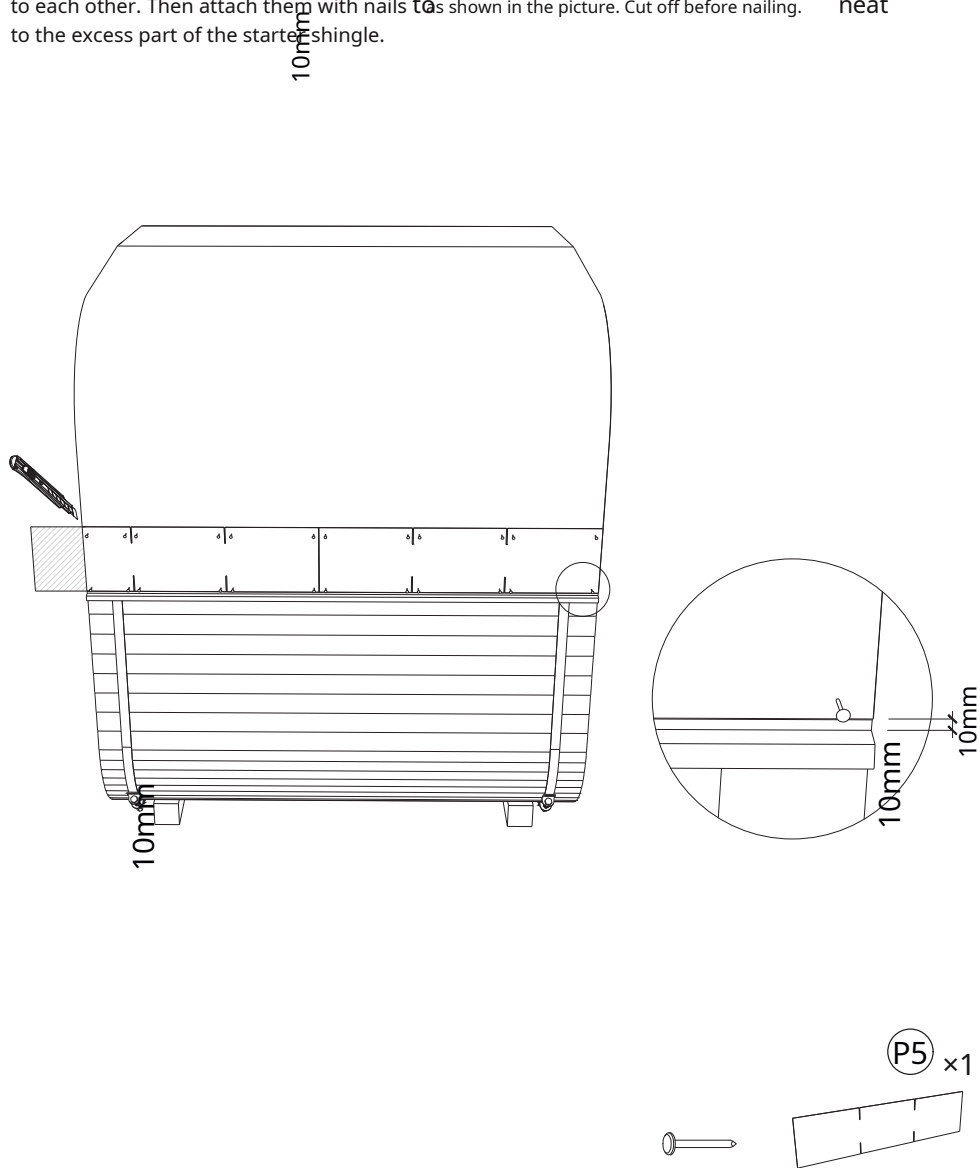

**KROTo 31:** Remove the protective film from the bottom of the sheet. Start laying the shingles on the with the starting shingle. Cut half of the rectangle from the entire shingle and attach with her game nails. Attach the next shingle next to the first.

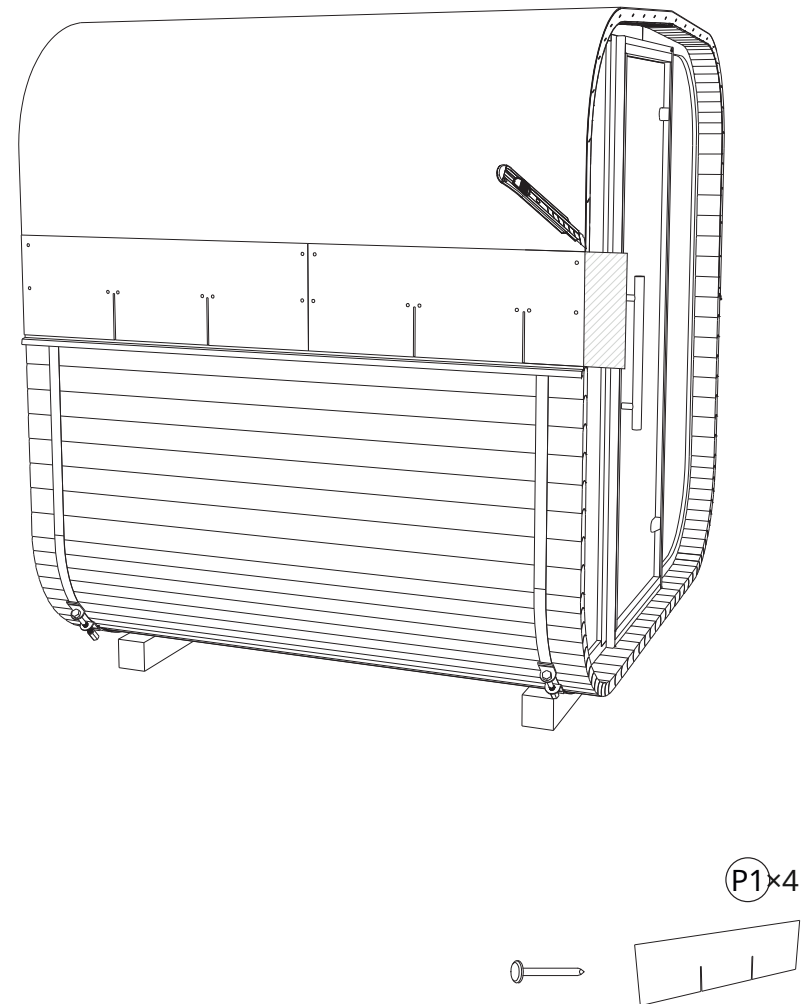

## INSTALLATION

**STEP 32:** Remove the protective film from the bottom of the sheet. The second row starts with a full shingle, attach it with shingle nails.

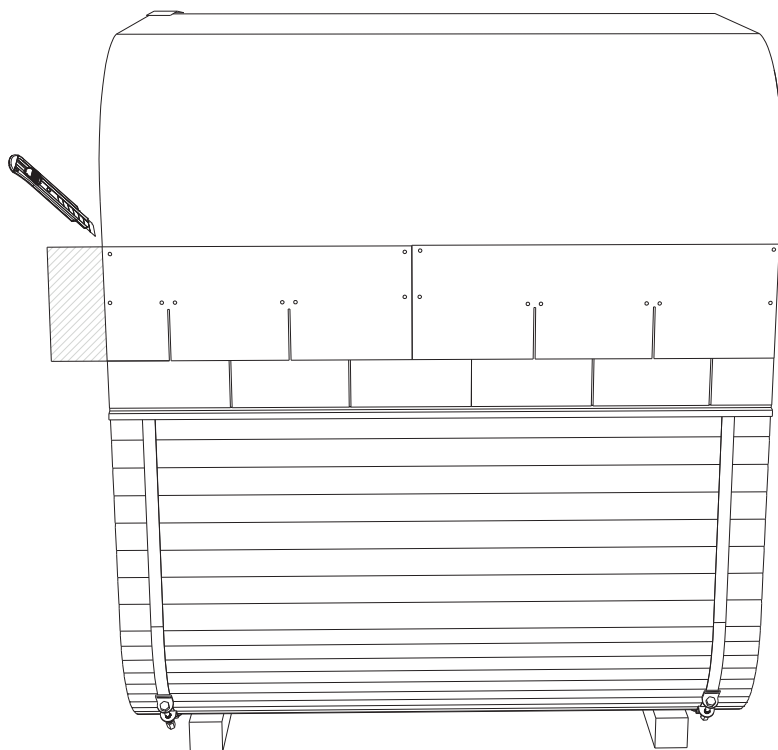

**STEP 33:** Remove the protective film from the bottom of the sheet. The third row goes exactly as first row. Cut a half rectangle out of the shingle and attach it with shingle nails.

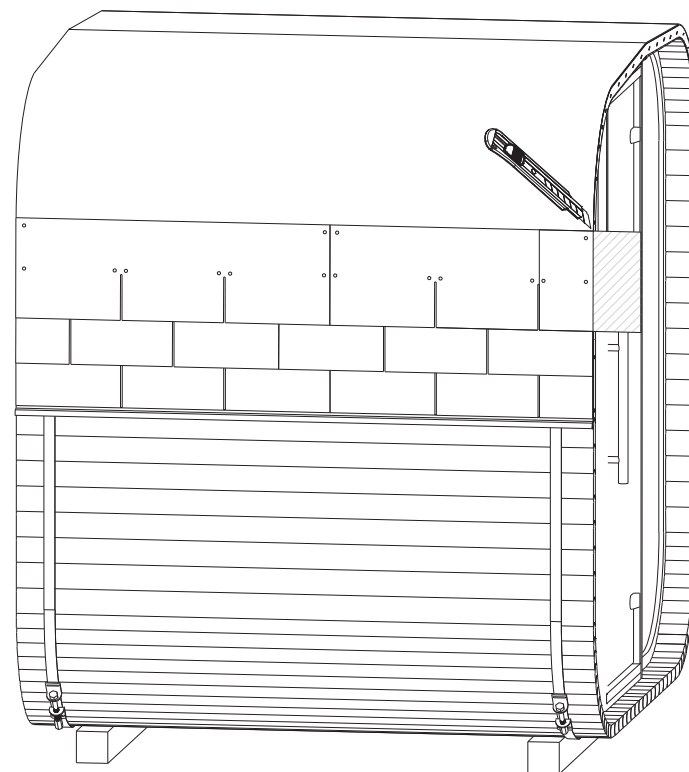

## INSTALLATION

**STEP 34:** Continue laying shingles until the last layer passes over the center of the roof.

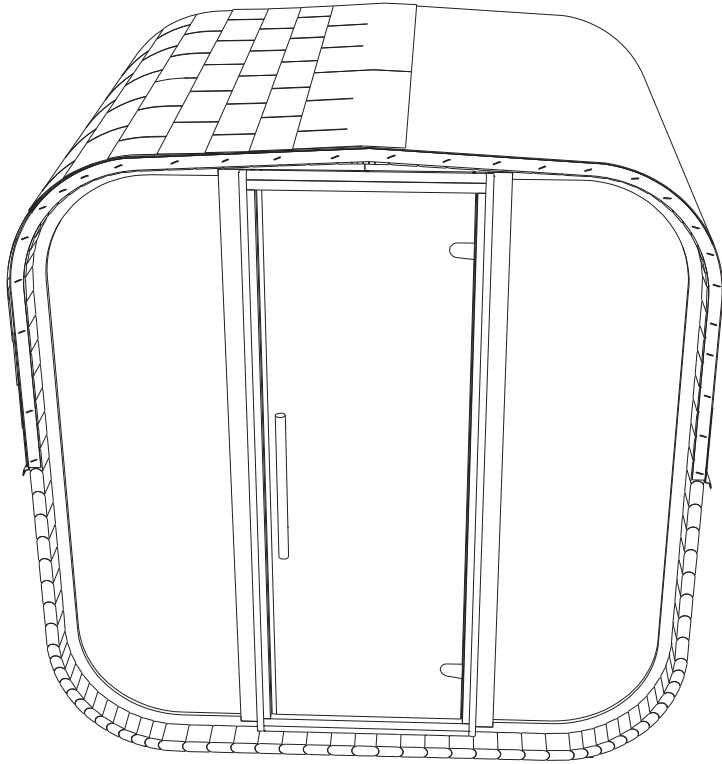

**STEP 35:** Repeat the same process Use a heat source until the last layer is tacky. Lift each across the center of the roof. For better rectangle, adhesion, heat it a little and press it to E roof.

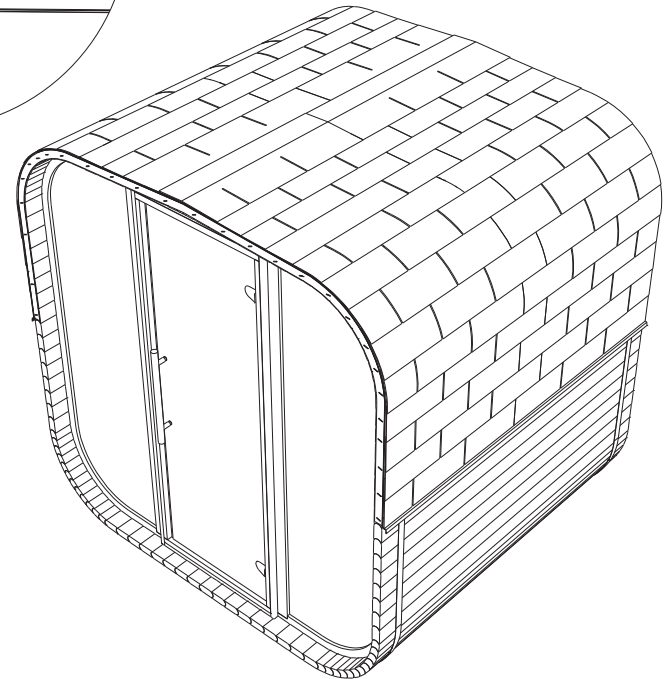
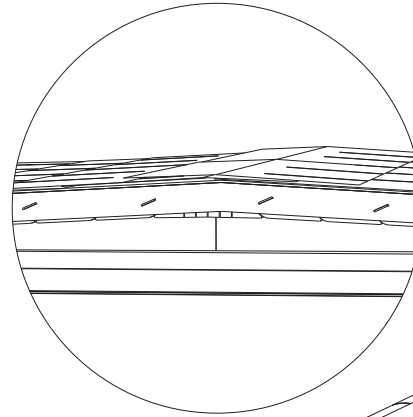

## INSTALLATION

**STEP 36:** Use starter shingles for the top of the roof. Cut several shingles into squares, with lines marked on them. Remove the protective film. Nail each shingle with two nails. The next shingle goes about 160 mm from the previous one. When finished, use a heat source for better adhesion.

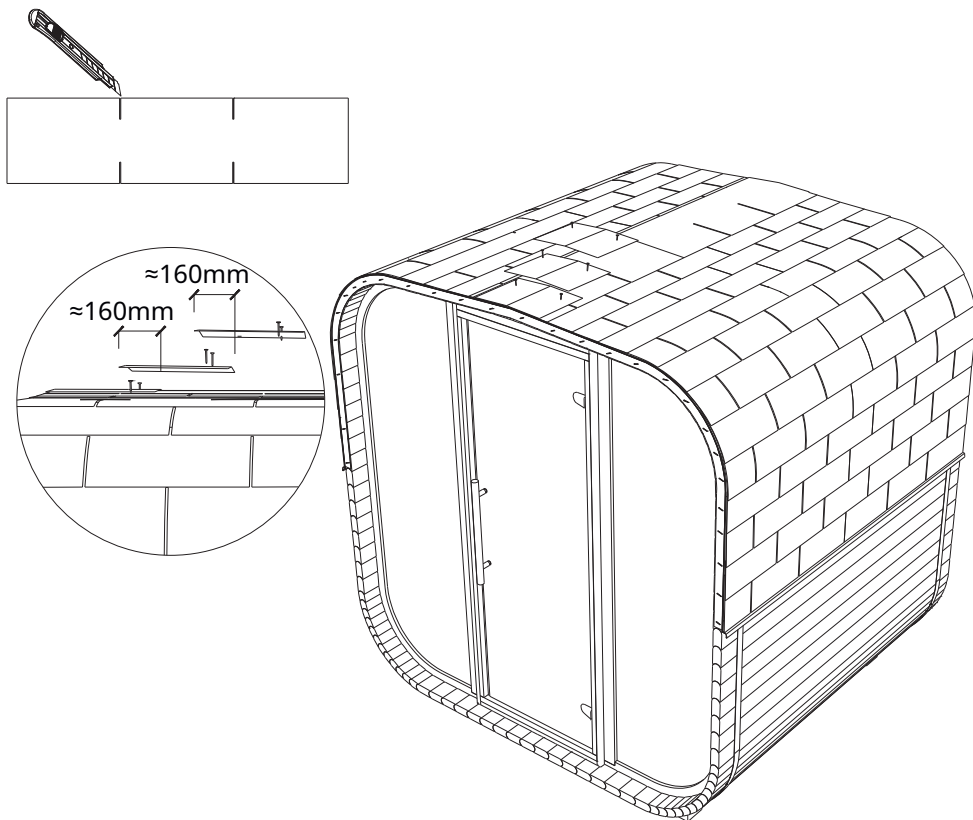

**STEP 37:** P will help(S7) Install the front and rear roof trim panels. Start with the top attachment two panels, the rest go side by side.

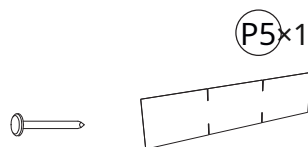
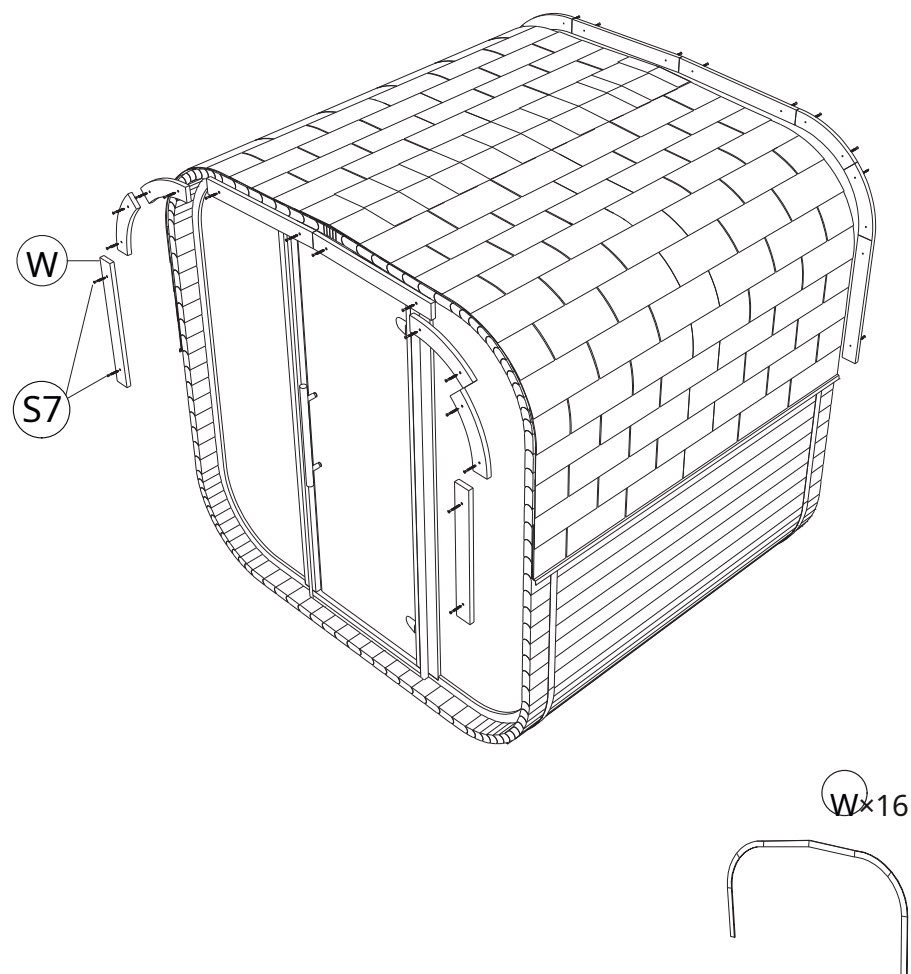

**STEP 38:** Use bitumen sealant behind the decorative boards to fill the gap between the shingle and the boards.

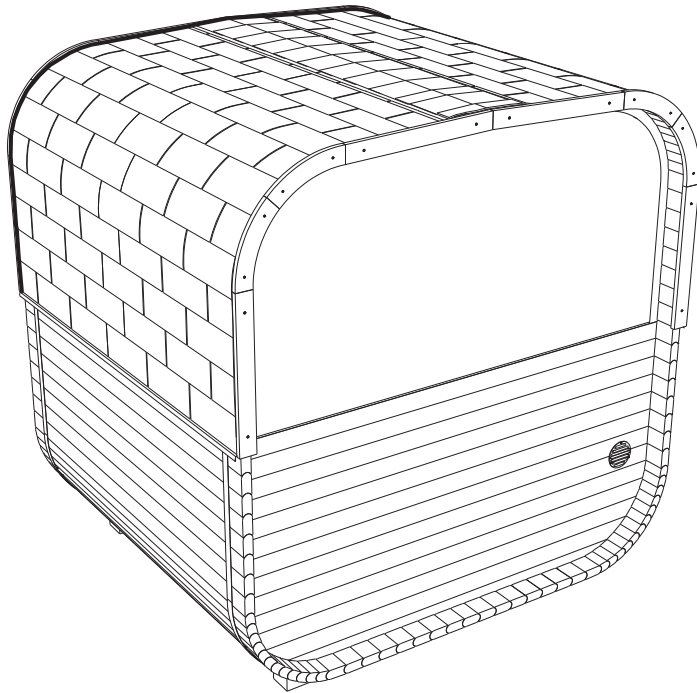

(P4) x 1



